

EN

INSTRUCTIONS
AIR COOLER



Table of contents

Information on the use of these instructions 2

Safety 2

Information about the device..... 5

Transport and storage..... 6

Assembly and start-up..... 6

Operation 10

Available accessories..... 13

Errors and faults..... 13

Maintenance 14

Technical annex..... 18

Disposal 18

Information on the use of these instructions

Symbols

 **Warning of electrical voltage**
 This symbol indicates dangers to the life and health of persons due to electrical voltage.

 **Warning**
 This signal word indicates a hazard with an average risk level which, if not avoided, can result in serious injury or death.

 **Caution**
 This signal word indicates a hazard with a low risk level which, if not avoided, can result in minor or moderate injury.

Notice
 This signal word indicates important information (e.g. material damage), but does not indicate hazards.

 **Info**
 Information marked with this symbol helps you to carry out your tasks quickly and safely.

 **Follow the manual**
 Information marked with this symbol indicates that the instructions must be observed.

You can download the current version of the instructions and the EU declaration of conformity via the following link:

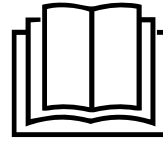

PAE 21



<https://hub.trotec.com/?id=43267>

Safety

Read this manual carefully before starting or using the device. Always store the manual in the immediate vicinity of the device or its site of use.

-  **Warning**
Read all safety warnings and all instructions. Failure to follow the warnings and instructions may result in electric shock, fire and/or serious injury. **Save all warnings and instructions for future reference.**
- This appliance can be used by children aged from 8 years and above and persons with reduced physical, sensory or mental capabilities or lack of experience and knowledge if they have been given supervision or instruction concerning use of the appliance in a safe way and understand the hazards involved. Children shall not play with the appliance. Cleaning and user maintenance shall not be made by children without supervision.
- Do not use the device in potentially explosive rooms or areas and do not install it there.
 - Do not use the device in aggressive atmosphere.
 - Place the device in an upright and stable position on horizontal and stable ground.
 - Let the device dry out after a wet clean. Do not operate it when wet.
 - Do not use the device with wet or damp hands.
 - Do not expose the device to directly squirting water.
 - Do not cover the device during operation.
 - Do not sit on the device.
 - This appliance is not a toy. Keep away from children and animals. Do not leave the device unattended during operation.
 - Occasionally observe the device during operation.
 - Check accessories and connection parts for possible damage prior to every use of the device. Do not use any defective devices or device parts.

- Ensure that all electric cables outside of the device are protected from damage (e.g. caused by animals). Never use the device if electric cables or the power connection are damaged!
- The mains connection must correspond to the specifications in the Technical annex.
- Insert the mains plug into a properly fused mains socket.
- Observe the device's power input, cable length and intended use when selecting extensions to the power cable. Completely unroll extension cables. Avoid electrical overload.
- Do not under any circumstances use the device if you detect damages on the mains plug or power cable. If the power cable is damaged, it must be replaced by the manufacturer, its service agent or similarly qualified persons in order to avoid a hazard. Defective power cables pose a serious health risk!
- Before carrying out maintenance, care or repair work on the device, remove the mains plug from the mains socket. Hold onto the mains plug while doing so.
- Switch the device off and disconnect the power cable from the mains socket when the device is not in use.
- When positioning the device, observe the minimum distances from walls and other objects as well as the storage and operating conditions specified in the Technical annex.
- Make sure that the air inlet and outlet are not obstructed.
- Make sure that the suction side is kept free of dirt and loose objects.
- Never insert any objects or limbs into the device.
- Do not remove any safety signs, stickers or labels from the device. Keep all safety signs, stickers and labels in legible condition.
- Only transport the device in an upright position with an emptied water tank.
- Empty and clean the water tank prior to storage or transport. Do not drink the water. Health hazard!
- Never leave water in the water tank when the appliance is not in use.
- Make sure that objects in the surroundings of the device do not become wet or damp. If moisture is present, the output must be reduced. Set the device to a lower level. If the output cannot be reduced, the device must only be operated in intervals. If necessary, switch the device off completely for a short time. Ensure that absorbent materials such as carpeting, curtains, sheers or tablecloths will not become damp.
- Note that high humidity levels may enhance the growth of biological organisms in the environment.
- Make sure that the water in the water tank is replaced every 3 days. Otherwise there is a risk of microorganisms growing in the water tank which presents a health hazard if they get into the air or water.
- Only fill the water tank with fresh drinking water, ice cubes made of fresh drinking water and / or suitable ice packs.
- Ice packs are not toys. Keep away from children and animals.
- Never open an ice pack. The liquid inside the ice packs can be harmful to health.
- Do not eat the ice that may form on the ice packs. Health hazard!
- Do not use the device if it has been dropped or if it shows visible signs of damage.
- Only use original spare parts, for otherwise safe and functional operation cannot be ensured.
- Switch the device off and disconnect the power cable from the mains socket before cleaning the device or before filling the water tank with water.
- Do not run the mains cable in front of the air outlet or in its immediate vicinity.
- Do not wrap the mains cable around the device and do not kink it to avoid damaging the cable insulation. Do not place any objects on the mains cable.

Intended use

Only use the device for cooling the air in interior spaces while adhering to and following the technical data.

Intended use comprises cooling the air in:

- living spaces
- museums
- warehouses and archives
- libraries
- call centres and computer rooms

Any use other than the intended use is regarded as misuse.

Reasonably foreseeable misuse

- Do not place the device on wet or flooded ground, e.g. near floor drains.
- Do not place any objects, e.g. clothing, on the device.
- Do not use the device out of doors.
- Do not use the device in the immediate vicinity of swimming pools, bathtubs and showers.
- Never immerse the device in water.
- Do not make any unauthorised modifications, alterations or structural changes to the device.

Personnel qualification

People who use this device must:

- be aware of the dangers that occur when working with electric devices in damp areas.
- have read and understood the instructions, especially the Safety chapter.



Maintenance tasks which require the housing to be opened must only be carried out by specialist electrical companies or by the manufacturer.

Safety signs and labels on the device

Notice

Do not remove any safety signs, stickers or labels from the device. Keep all safety signs, stickers and labels in legible condition.

The following safety signs and labels are attached to the device:

Symbols	Meaning
	This symbol located on the device indicates that the filter has to be checked and, if necessary, to be cleaned prior to each operation. Replace the filter if it is defective. Do not insert a wet filter into the device. Wait until the filter has dried.
	This symbol located on the device indicates that the water tank should be cleaned every 3 days. Change the water in the water tank every 3 days. Disconnect the device from the mains before cleaning the water tank.

This label can be found on the device in English and German.

Operate the device with the adapter supplied by the manufacturer.

Residual risks



Warning of electrical voltage

Work on the electrical components must only be carried out by an authorised specialist company!



Warning of electrical voltage

Risk of electric shock!
The device is not protected against water. There is a risk of electric shock!
Never use the device in areas where dripping, spraying or running water can enter the device! Never immerse the device in water!



Warning of electrical voltage

Risk of electric shock!
Risk of an electric shock if the device comes into contact with water!
Do not use this device in the immediate vicinity of bathtubs, showers or swimming pools!



Warning of electrical voltage

Before any work on the device, remove the mains plug from the mains socket!
Do not touch the mains plug with wet or damp hands. Hold onto the mains plug while pulling the power cable out of the mains socket.



Warning

The liquid inside the ice packs can be harmful to health!
If the liquid was swallowed, immediately seek medical attention.
If the liquid came into contact with your eyes, rinse with water and immediately consult an ophthalmologist.



Warning

Dangers can occur at the device when it is used by untrained people in an unprofessional or improper way! Observe the personnel qualifications!



Warning

The device is not a toy and does not belong in the hands of children.



Warning

Risk of suffocation!
Do not leave the packaging lying around. Children may use it as a dangerous toy.

Notice

Do not operate the device without an air filter inserted into the air inlet!
Without the air filter, the inside of the device will be heavily contaminated. This can reduce the performance and result in damage to the device.

Behaviour in the event of an emergency

1. Switch the device off.
2. Disconnect the device from the mains: Hold onto the mains plug while pulling the power cable out of the mains socket.
3. Do not reconnect a defective device to the mains.

Information about the device

Device description

The air cooler lowers the room temperature to a comfortable degree by evaporation-based cooling.

The device is filled with cold water or optionally with ice cubes and / or ice packs in order to cool down the incoming warm air at the evaporation filter and to blow out the cold air thus generated via the fan.

Besides its cooling function, the device can also be used for air freshening: thanks to an integrated air filter and the evaporation filter's honeycomb structure, the sucked-in air is filtered and humidified.

The fan speed can be set to three stages.

The discharge direction of the cooled air can be manually adjusted via the ventilation flaps as well as via the optionally selectable automatic swing mode.

The device can be operated via the control panel at the device.

Device depiction

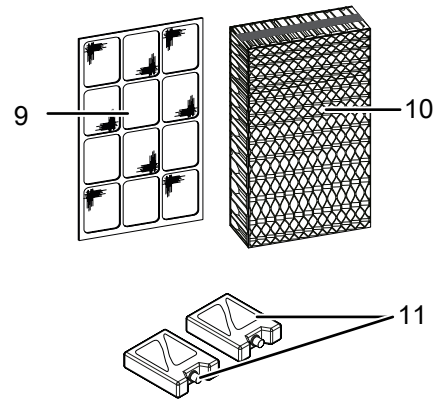
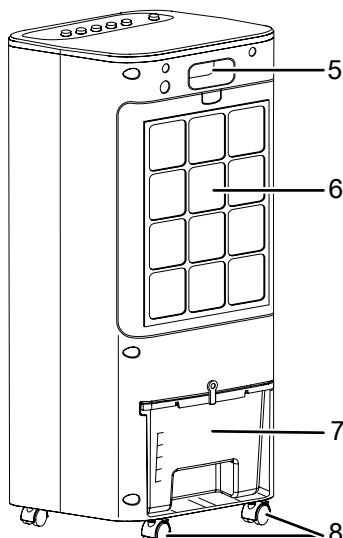
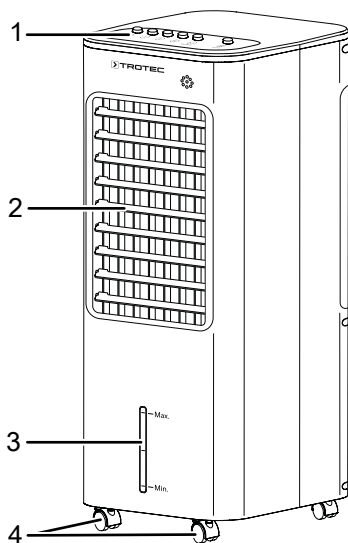

No.	Designation
1	Control panel
2	Air outlet with adjustable ventilation flaps and air flaps for swing function
3	Water level indicator
4	Wheels
5	Transport handle
6	Air inlet with air filter and evaporation filter
7	Water tank with filling level indicator
8	Wheels with parking brake
9	Air filter
10	Evaporation filter
11	Ice packs

Transport and storage

Notice

If you store or transport the device improperly, the device may be damaged.

Note the information regarding transport and storage of the device.

Transport

To make the device easier to transport, it is fitted with wheels.

To make the device easier to transport, it is fitted with a carry handle.

Before transporting the device, observe the following:

- Switch the device off.
- Hold onto the mains plug while pulling the power cable out of the mains socket.
- Empty the water tank.
- Do not use the power cable to drag the device.
- Release the brakes at the castors.
- Only wheel the device on firm and level surfaces.

After transporting the device, proceed as follows:

- Set up the device in an upright position after transport.

Storage

Before storing the device, proceed as follows:

- Empty and clean the water tank prior to storage (see chapter Maintenance).
- Allow the evaporation filter to dry prior to storage. Otherwise the device may distribute a musty smell after restart.
- Hold onto the mains plug while pulling the power cable out of the mains socket.

When the device is not being used, observe the following storage conditions:

- Store the device in a dry location and protected from frost and heat.
- Store the device in an upright position where it is protected from dust and direct sunlight.
- If required, use a cover to protect the device from invasive dust.
- Place no further devices or objects on top of the device to prevent it from being damaged.

Assembly and start-up

Scope of delivery

- 1 x Device
- 1 x Evaporation filter
- 1 x Air filter
- 2 x Wheel
- 2 x Wheel with parking brake
- 2 x Ice pack
- 1 x Manual

Unpacking the device

1. Open the cardboard box and take the device out.
2. Completely remove the packaging.
3. Fully unwind the power cable. Make sure that the power cable is not damaged and that you do not damage it during unwinding.

Start-up

When positioning the device, observe the minimum distance from walls or other objects as described in the chapter Technical annex.

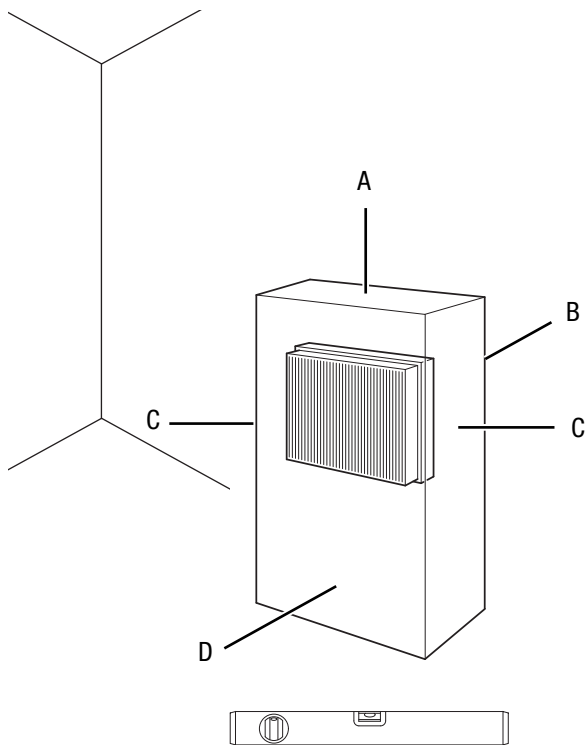

- Before restarting the device, check the condition of the power cable. If there are doubts as to the sound condition, contact the customer service.
- Place the device in an upright and stable position on horizontal and stable ground.
- Do not create tripping hazards when laying the power cable or other electric cables, especially when positioning the device in the middle of the room. Use cable bridges.
- Make sure that extension cables are completely unrolled.
- Make sure that no curtains or other objects interfere with the air flow.

Observe the following before operating the device after a period of non-use or after the device has been stored:

- Clean the housing and the water tank prior to recommissioning (see chapter Maintenance).

Mounting the wheels

To ensure simple transportation and a stable position, the supplied wheels must be mounted. To do so, please proceed as follows:

Notice

When mounting the wheels, make sure that the filled water tank is not located inside the device.

1. Place the device on its side and insert a roller. Repeat this step for the 3 remaining wheels.
 - ⇒ Please note that the wheels equipped with a parking brake ought to be positioned at the front of the device.

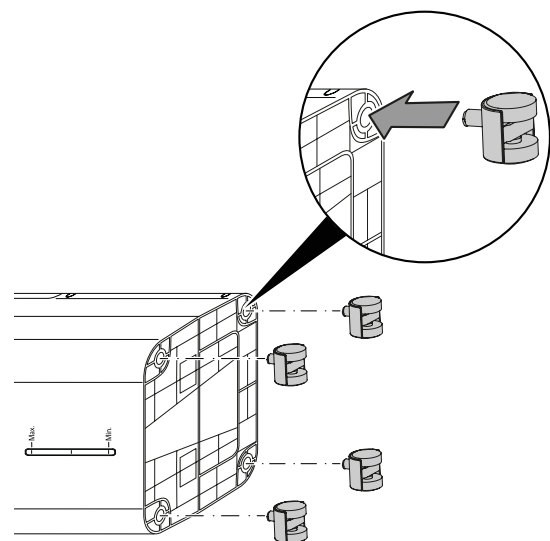

- To facilitate easy transport, release the parking brakes.

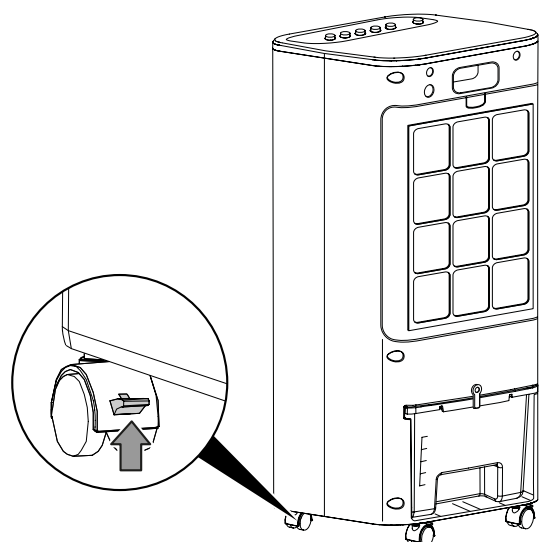

- To ensure a firmly fixed position, apply the parking brakes.

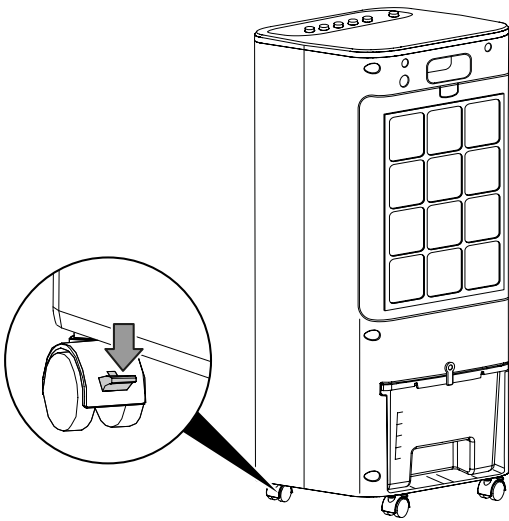

Filling the water tank

The device requires fresh drinking water for air cooling.

Notice

Fill the device with fresh drinking water only. The water temperature must not exceed 40 °C.



Info

If possible, change the water every 3 days to prevent bacterial growth.

Observe the following when using the ice packs:

- Put the ice packs into a freezer for at least 4 hours before use.
- Put the ice packs into the water tank before filling water into the tank.



Info

When using ice packs at high outside temperatures, condensation may form at the water tank and drip onto the floor.

1. Disconnect the device from the mains before refilling water or putting ice packs into the device.
2. Release the water tank by turning the clip upwards.

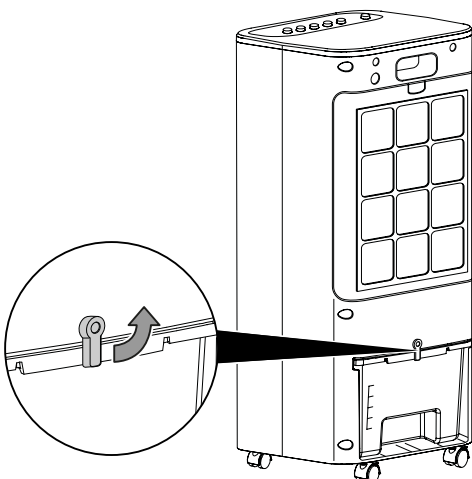

3. Pull the water tank out a little from the device.



Info

There are two ways to fill the water tank:

Version A: Pull the water tank out of the device as far as possible and use a suitable vessel to fill the water tank. Please note that you cannot pull the water tank completely out of the device since there is a pump installed in the water tank. Continue with step 6 in this case.

Version B: Completely remove the water tank from the device and then fill the water tank. To do so, follow steps 4 and 5.

4. Release the pump and remove it from the water tank by turning the locking lever 90° clockwise. While doing this, make sure not to damage or loosen the connected cable or the hose attached to the pump.

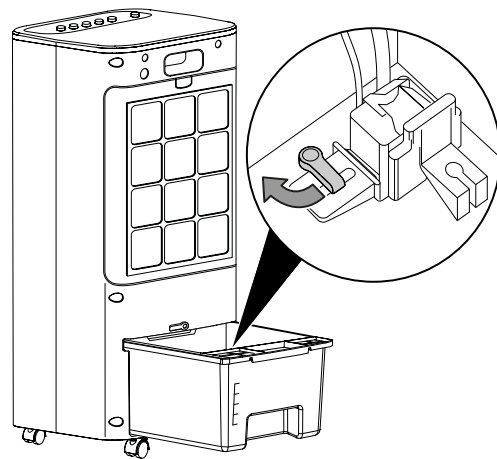

5. Remove the water tank from the device.
6. Fill the water tank with fresh drinking water only. Optionally, you can add ice cubes made of drinking water for additional cooling.
 - ⇒ Observe the minimum and maximum filling level at the filling level indicator. The water tank must be filled up to minimum filling level to enable pump operation.

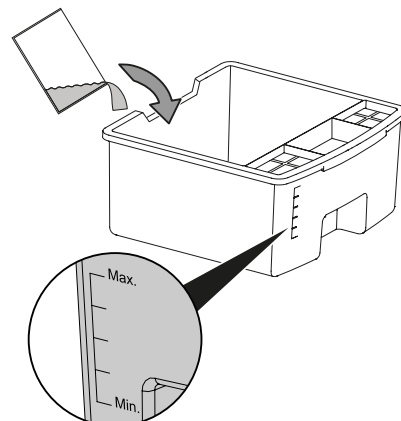

- If required, put the ice packs into the water tank for additional cooling.

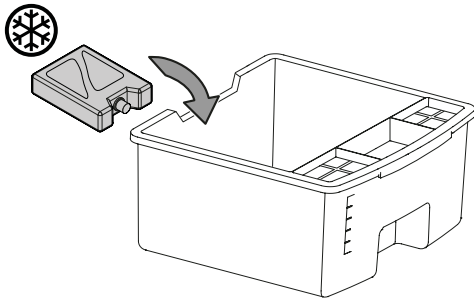

- Reinsert the water tank into the device and, if applicable, secure the pump in the water tank by inserting the pump into the retainer and turning the locking lever 90° counter-clockwise.
- Lock the water tank by turning the clip from its horizontal position into the vertical position.

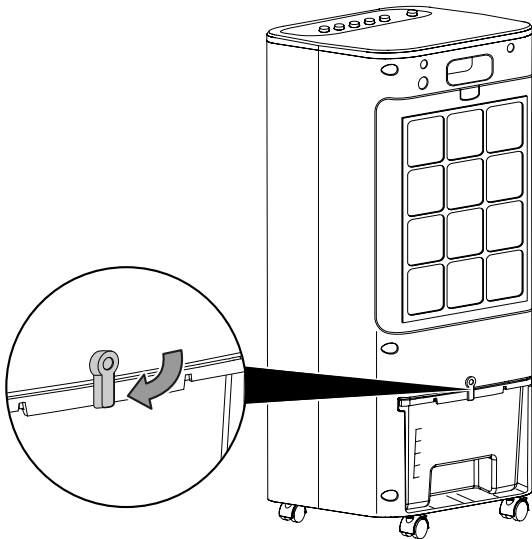

- Make sure that the device is neither damp nor wet on the outside. Otherwise wipe it dry.

Inserting evaporation filter and air filter

Notice

When set to air cooling mode, the device must not be operated without the evaporation filter, otherwise *cooling* will not work.

Notice

Do not operate the device without an air filter inserted into the air inlet!

Without the air filter, the inside of the device will be heavily contaminated. This can reduce the performance and result in damage to the device.

Notice

For an even distribution of water please make sure that the groove of the evaporation filter is positioned at the top.

- Make sure that both the evaporation and the air filter are installed before switching the device on.

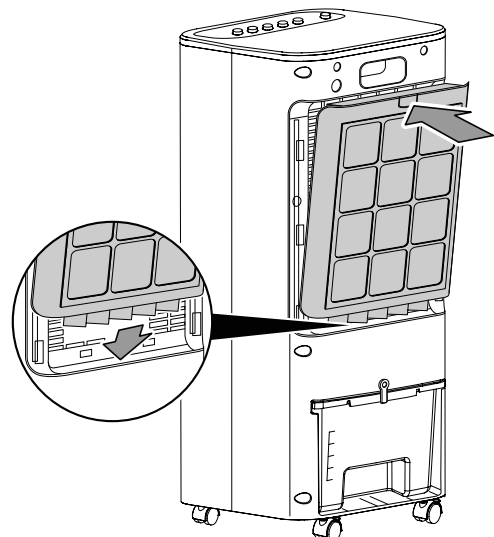
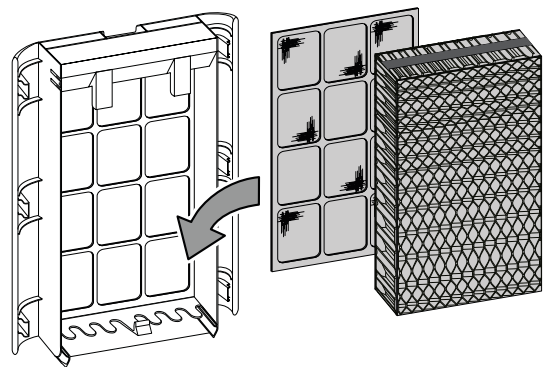

Opening the ventilation flaps

- Prior to switching the device on, adjust the ventilation flaps at the air outlet.

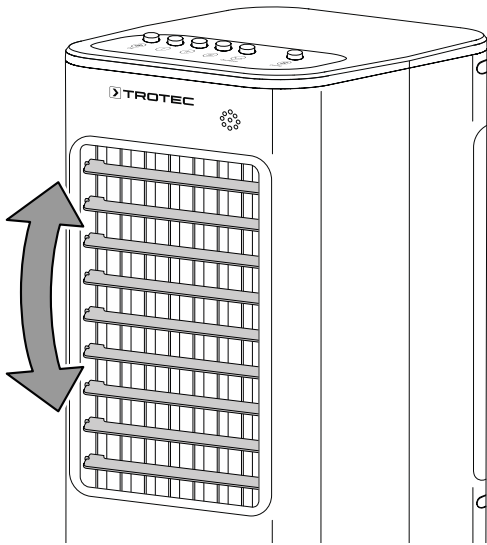

Connecting the power cable

- Insert the mains plug into a properly fused mains socket.

Operation

- Avoid open doors and windows.

Operating elements

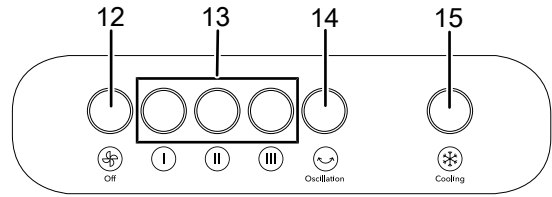

No.	Designation	Meaning
12	Off button	Switches ventilation off
13	Fan speed buttons	Setting the fan speed: I Stage 1 = low II Stage 2 = medium III Stage 3 = high
14	Oscillation button	Switching the swing function on or off
15	Cooling button	Switching air cooling on or off



Warning of electrical voltage

Risk of electric shock!
The device is not protected against water.
There is a risk of electric shock!
Never use the device in areas where dripping, spraying or running water can enter the device! Never immerse the device in water!

Switching the device on

Once you have completely installed the device as described in the Start-up chapter, you can switch it on.

Setting the operating mode

The device comes with the following operating modes:

- Ventilation
- Air cooling

Ventilation

Please proceed as follows to activate ventilation:

1. Press one of the fan speed buttons (13).
⇒ The device activates ventilation at the corresponding fan speed.
2. Press the Off button (12) to switch off ventilation.

Notice

Please note that the device does not switch off automatically.

Air cooling

When activating air cooling, the pump is switched on and the water is distributed over the evaporation filter to cool the circulating air.

Please proceed as follows to activate air cooling:

1. Press the *Cooling* button (15).
⇒ The pump switches on.
2. Press the *Cooling* button (15) again to switch off the pump and thus to deactivate air cooling.

Notice

Please note that pressing the *Off* button (12) does not switch off the pump for air cooling. The *Off* button (12) only deactivates ventilation.

Notice

When *air cooling* mode is activated, the water tank must not be removed, otherwise the water from the filter will drip down into the device.

Swing function

The swing function can be switched on in any operating mode if required.

Behind the horizontal ventilation flaps, there are vertical air flaps integrated in the device. By means of the swing function, these air flaps are moved automatically and thus ensure continuous air circulation.

Press the *Oscillation* button (14) to switch the swing function on or off.

Adding water

If you want to use air cooling mode, the water tank must be filled as soon as it is empty.

Observe the following when using the ice packs:

- Put the ice packs into a freezer for at least 4 hours before use.
- Put the ice packs into the water tank before filling water into the tank.



Info

When using ice packs at high outside temperatures, condensation may form at the water tank and drip onto the floor.

1. Disconnect the device from the mains before refilling water or putting ice packs into the device.
2. Release the water tank by turning the clip upwards.

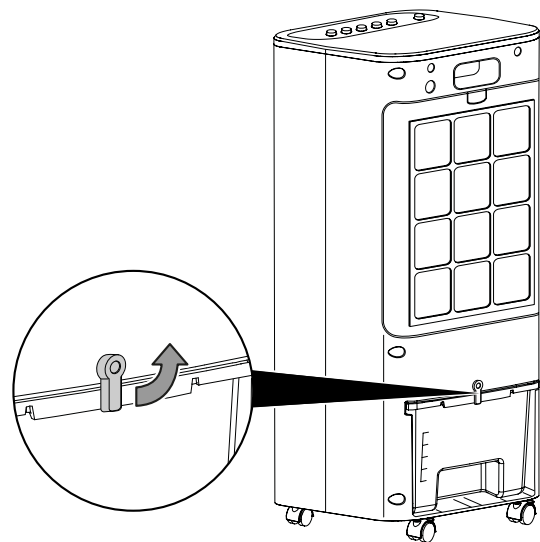

3. Pull the water tank out a little from the device.



Info

There are two ways to fill the water tank:

Version A: Pull the water tank out of the device as far as possible and use a suitable vessel to fill the water tank. Please note that you cannot pull the water tank completely out of the device since there is a pump installed in the water tank. Continue with step 6 in this case.

Version B: Completely remove the water tank from the device and then fill the water tank. To do so, follow steps 4 and 5.

- Release the pump and remove it from the water tank by turning the locking lever 90° clockwise. While doing this, make sure not to damage or loosen the connected cable or the hose attached to the pump.

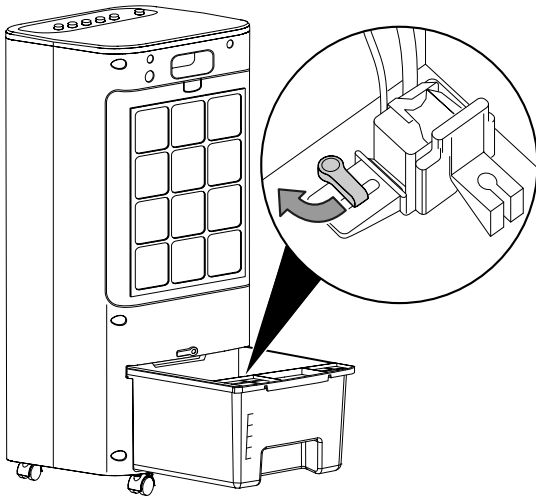

- If required, put the ice packs into the water tank for additional cooling.

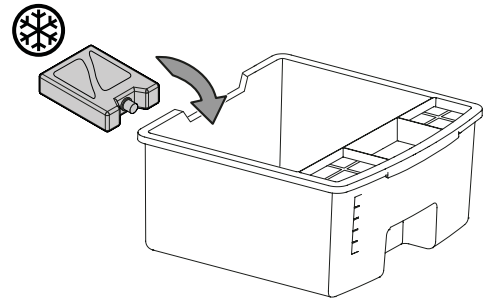

- Reinsert the water tank into the device and, if applicable, secure the pump in the water tank by inserting the pump into the retainer and turning the locking lever 90° counter-clockwise.
- Lock the water tank by turning the clip from its horizontal position into the vertical position.

- Remove the water tank from the device.
- Fill the water tank with fresh drinking water only. Optionally, you can add ice cubes made of drinking water for additional cooling.
 - ⇒ Observe the minimum and maximum filling level at the filling level indicator. The water tank must be filled up to minimum filling level to enable pump operation.

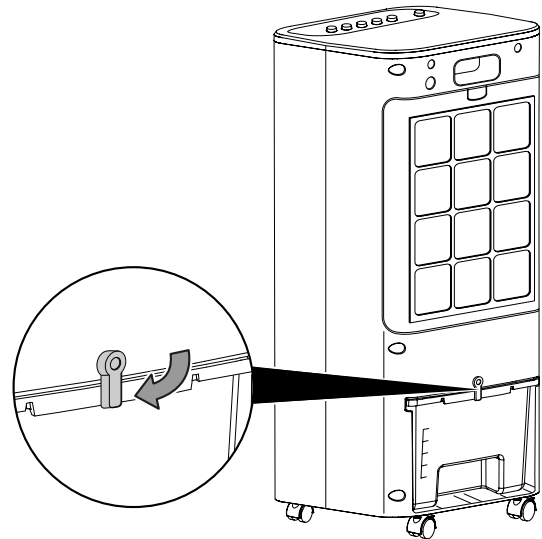
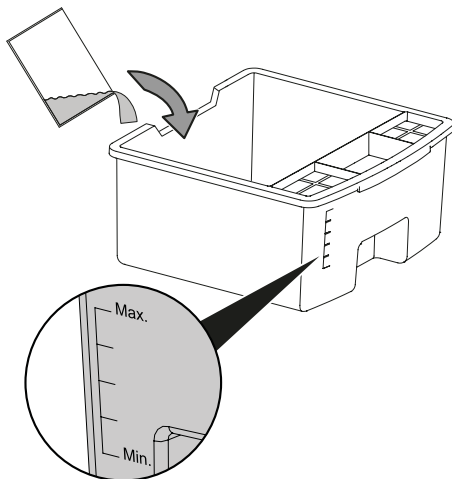

- Make sure that the device is neither damp nor wet on the outside. Otherwise wipe it dry.

Switching the device off

Switch the device off by removing the mains cable from the mains socket. Hold onto the mains plug while doing so.

Shutdown



Warning of electrical voltage

Do not touch the mains plug with wet or damp hands.

- Switch the device off by removing the mains cable from the mains socket. Hold onto the mains plug while doing so.
- Empty and clean the water tank (see chapter Maintenance).
- Clean the device according to the Maintenance chapter.
- Store the device according to the Transport and storage chapter.

Available accessories



Warning

Only use accessories and additional equipment specified in the instructions.
Using insertion tools or accessories other than those specified in the instructions may cause a risk of injury.

Designation	Article number
Evaporation filter PAE 21	7.710.000.865

Errors and faults

The device has been checked for proper functioning several times during production. If malfunctions occur nonetheless, check the device according to the following list.

Notice

Wait for at least 3 minutes after maintenance and repair work. Only then switch the device back on.

The device does not start:

- Check the power connection.
- Check the power cable and mains plug for damage.
- Check the on-site fusing.

The device works with reduced or no capacity:

- Check the position of the horizontal ventilation flaps. They should be opened to the maximum.
- Check the air filter for dirt. If necessary, clean or replace the air filter.
- Check the minimum distance to walls or other objects. Position the device a little more in the room's centre if required.

The device is running, but there is no air cooling or pump operation:

- Check whether *air cooling* mode is activated.
- Check the filling level of the water tank (see Filling the water tank).
- Check whether there are any objects blocking the pump inlet. Make sure that the pump inlet is not blocked.
- In case the pump does not operate despite a correctly filled water tank and activated air cooling mode, the pump might be defective. Please contact the customer service.
- Make sure that the pump is correctly installed and secured in the water tank (see Filling the water tank).

Water is leaking:

- Check the device for leaks.
- Check the water tank for tight fit.

The swing function is not working:

- The swing function motor might be defective. Please contact the customer service.

The device is loud or vibrates:

- Check whether the device is set up in a stable and upright position.

The device still does not operate correctly after these checks:

Please contact the customer service. If necessary, bring the device to an authorised specialist electrical company or to the manufacturer for repair.

Maintenance

Maintenance intervals

Maintenance and care interval	before every start-up	as needed	every 3 days	at least every 2 weeks	at least every 4 weeks
Clean the water tank			X		
Check air inlets and outlets for dirt and foreign objects and clean if necessary	X				X
Clean the exterior		X			
Visually check the inside of the device for dirt		X			
Check the air filter for dirt and foreign objects and clean if necessary	X			X	
Replacing the evaporation filter		X			
Check for damage	X				
Check the attachment screws		X			
Test run					

Maintenance and care log

Device type:

Device number:

Maintenance and care interval	1	2	3	4	5	6	7	8	9	10	11	12	13	14	15	16
Clean the water tank																
Check air inlets and outlets for dirt and foreign objects and clean if necessary																
Clean the exterior																
Visually check the inside of the device for dirt																
Check the air filter for dirt and foreign objects and clean if necessary																
Replacing the evaporation filter																
Check for damage																
Check attachment screws																
Test run																
Remarks:																

1. Date:	2. Date:	3. Date:	4. Date:
Signature:	Signature:	Signature:	Signature:
5. Date:	6. Date:	7. Date:	8. Date:
Signature:	Signature:	Signature:	Signature:
9. Date:	10. Date:	11. Date:	12. Date:
Signature:	Signature:	Signature:	Signature:
13. Date:	14. Date:	15. Date:	16. Date:
Signature:	Signature:	Signature:	Signature:

Activities required before starting maintenance



Warning of electrical voltage

Do not touch the mains plug with wet or damp hands.

- Switch the device off.
- Hold onto the mains plug while pulling the power cable out of the mains socket.



Warning of electrical voltage

Tasks which require the device to be opened must only be carried out by authorised specialist companies or by the manufacturer.

Visual inspection of the inside of the device for dirt

1. Remove the air filter.
2. Use a torch to illuminate the openings of the device.
3. Check the inside of the device for dirt.
4. If you see a thick layer of dust, have the inside of the device cleaned by a specialist electrical company or by the manufacturer.
5. Put the air filter back in.

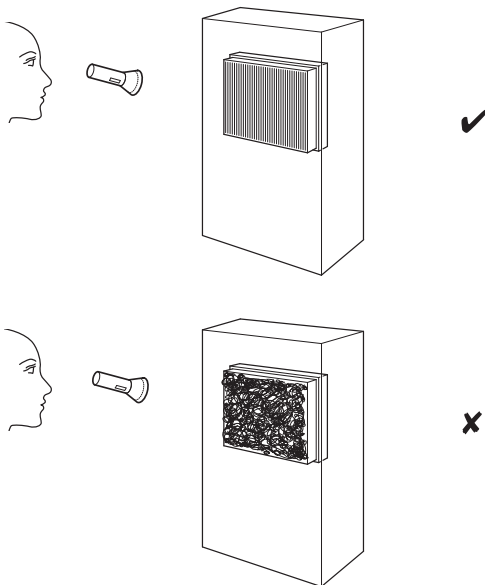

Cleaning the housing

Clean the housing with a soft, damp and lint-free cloth. Make sure that no moisture enters the housing. Protect electrical components from moisture. Do not use any aggressive cleaning agents such as cleaning sprays, solvents, alcohol-based or abrasive cleaners to dampen the cloth.

Cleaning the water tank

The water tank should be cleaned every 3 days if actively used. Empty and clean the water tank before a longer period of non-use or storage and prior to recommissioning (e.g. if the unit has been stored for several months and is dusty).

1. Release the water tank by turning the clip upwards.

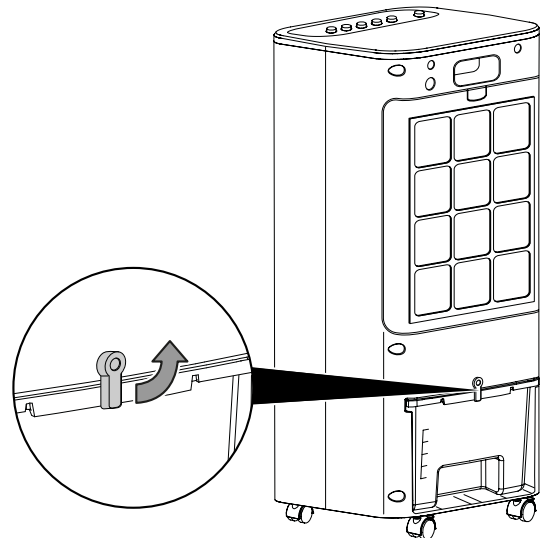

2. Pull the water tank out a little from the device.
3. Release the pump and remove it from the water tank by turning the locking lever 90° clockwise. While doing this, make sure not to damage or loosen the connected cable or the hose attached to the pump.

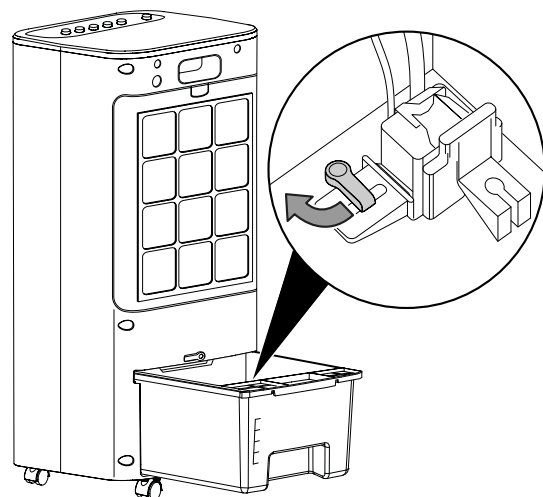

4. Remove the water tank from the device.
5. Thoroughly rinse the water tank with citric acid (descaling agent). Allow the citric acid to work for max. 20 minutes.
6. Then rinse the inside of the device with water.
7. Dry the inside of the tank with a lint-free cloth.
8. Fill the water tank with fresh drinking water if you want to continue operation (see chapter Adding water).
9. Secure the pump in the water tank by inserting the pump into the retainer and turning the locking lever 90° clockwise.

10. Refit the water tank into the device.
11. Lock the water tank by turning the clip from its horizontal position into the vertical position.

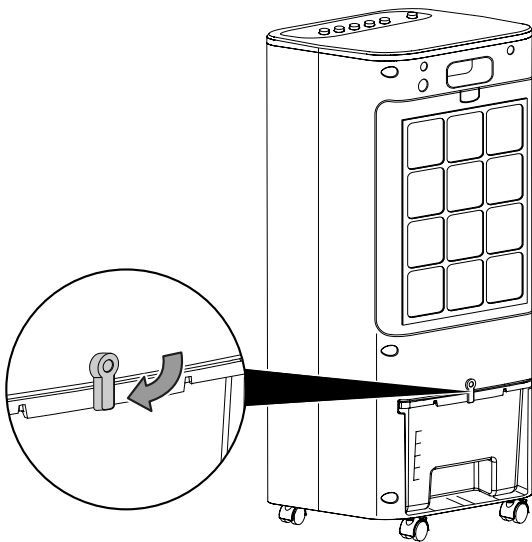

12. In doing so, make sure that the water tank is inserted correctly, for otherwise the device cannot be switched back on.

Cleaning the air filter

The air filter has to be cleaned as soon as it is dirty. This is brought to light e.g. by a reduced capacity (see chapter Errors and faults).



Warning

Ensure that the air filter is not worn or damaged. The corners and edges of the air filter must not be deformed or rounded. Before reinserting the air filter, make sure that it is undamaged and dry!

1. Remove the air filter from the device.

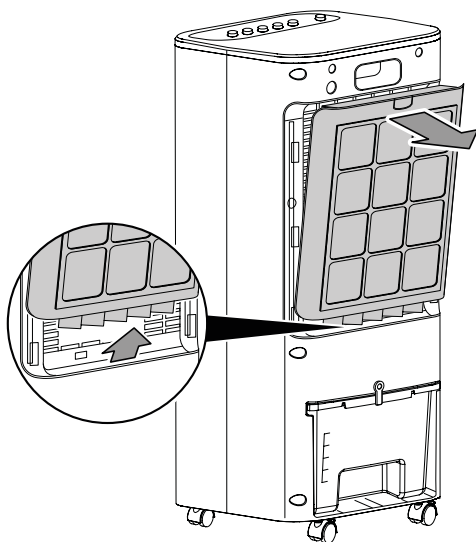

2. Remove the evaporation filter from the air filter.

3. Remove the air filter from the retainer.

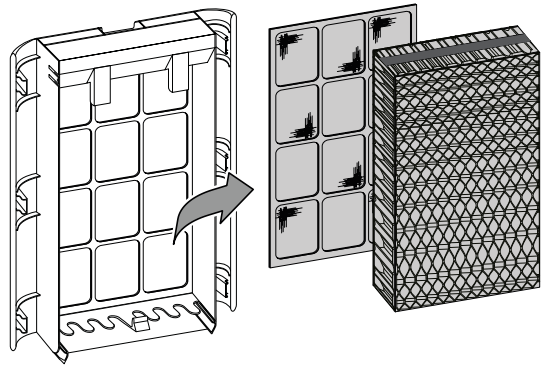

4. Clean the filter using a slightly damp, soft, lint-free cloth. If the filter is heavily contaminated, clean it with warm water mixed with a neutral cleaning agent.
5. Allow the filter to dry completely. Do not insert a wet filter into the device!
6. Reinsert the air filter into the retainer.
7. Reinsert the evaporation filter to the air filter.

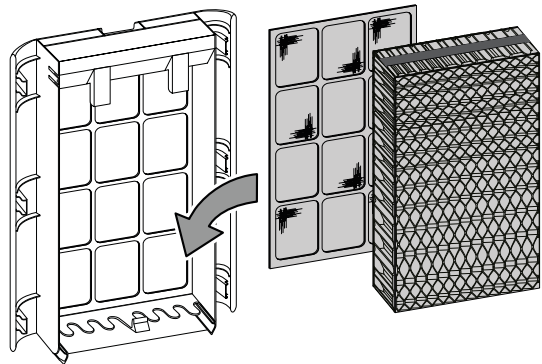

8. Reinsert the air filter into the device.

Replacing the evaporation filter

Notice

When set to air cooling mode, the device must not be operated without the evaporation filter, otherwise *cooling* will not work.

Notice

Do not operate the device without an inserted air filter! Without the air filter, the inside of the device will be heavily contaminated. This could reduce the performance and result in damage to the device.

Notice

For an even distribution of water please make sure that the groove of the evaporation filter is positioned at the top.

The evaporation filter should be replaced in case of heavy soiling.

In standard operation, the interval for replacing the evaporation filter is approx. 1 year.

Allow the evaporation filter to dry before removing it from the device.

1. Remove the air filter and the evaporation filter from the device.

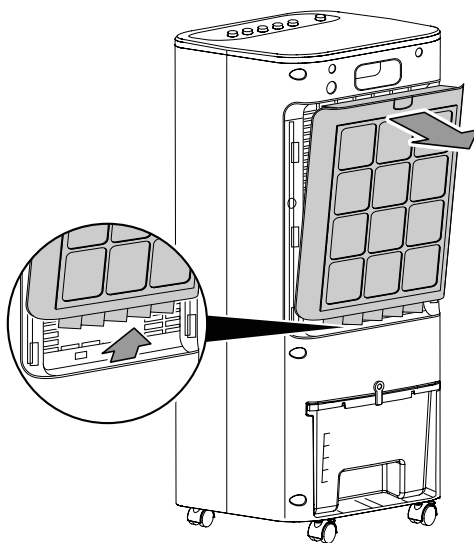

3. Dispose of used evaporation filter according to the national regulations.
4. Insert the new evaporation filter into the device.

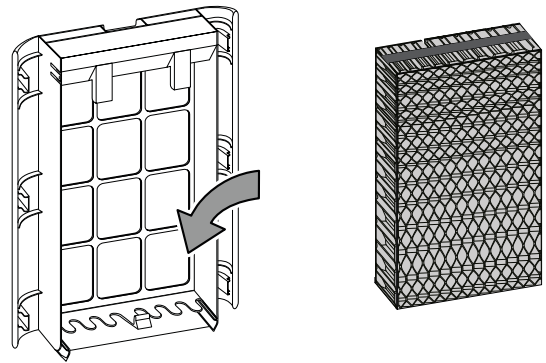

5. Reinsert the air filter into the device.

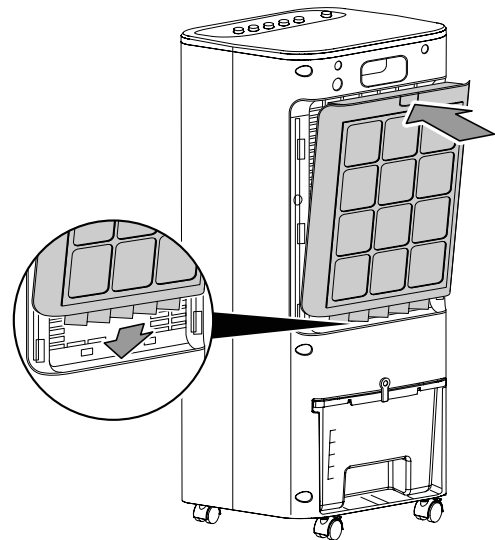

Activities required after maintenance

If you want to continue using the device:

- Reconnect the device to the mains.

If you do not intend to use the device for a considerable time:

- Store the device according to the Transport and storage chapter.

2. Remove the evaporation filter from the air filter.

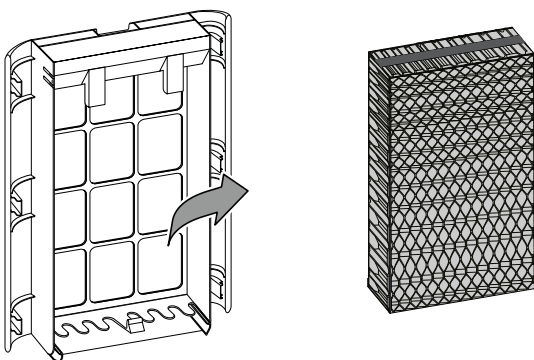

Technical annex

Technical data

Parameter	Value
Model	PAE 21
Evaporation capacity	800 ml/h
Air flow rate	276 m ³ /h
Mains connection	220–240 V / 50 Hz
Nominal current consumption	0.3 A
Power consumption	50 W
Sound pressure level (at a distance of 1 m)	60 dB(A)
Water tank capacity	5.6 l
Weight	6.5 kg
Dimensions (length x width x height)	290 x 260 x 700 mm
Minimum distance to walls and other objects:	
	top (A): 100 cm
	rear (B): 100 cm
	sides (C): 100 cm
	front (D): 100 cm

Information requirements for comfort fans according to Regulation (EU) No 206/2012:

PAE 21

Parameter	Symbol	Value	Unit
Maximum fan flow rate	F	4.23	m ³ /min
Fan power input	P	45.6	W
Service value	SV	0.09	(m ³ /min)/W
Standby mode power consumption	P _{SB}	-	W
Fan sound power level	L _{AW}	58.15	dB(A)
Maximum air velocity	c	1.07	m/s
Measurement standard for service value	EN ISO 5801:2017		
Contact details for obtaining more information	Trotec GmbH · Grebbener Straße 7 · 52525 Heinsberg		

Disposal

Always dispose of packing materials in an environmentally friendly manner and in accordance with the applicable local disposal regulations.



The icon with the crossed-out waste bin on waste electrical or electronic equipment is taken from Directive 2012/19/EU. It states that this device must not be disposed of with the household waste at the end of its life. You will find collection points for free return of waste electrical and electronic equipment in your vicinity. The addresses can be obtained from your municipality or local administration. You can also find out about other return options that apply for many EU countries on the website <https://hub.trotec.com/?id=45090>. Otherwise, please contact an official recycling centre for electronic and electrical equipment authorised for your country.

The separate collection of waste electrical and electronic equipment aims to enable the re-use, recycling and other forms of recovery of waste equipment as well as to prevent negative effects for the environment and human health caused by the disposal of hazardous substances potentially contained in the equipment.

Only for United Kingdom

According to Waste Electrical and Electronic Equipment Regulations 2013 (SI 2013/3113) (as amended) devices that are no longer usable must be collected separately and disposed of in an environmentally friendly manner.

Trotec GmbH

Grebener Str. 7
D-52525 Heinsberg

☎ +49 2452 962-400

☎ +49 2452 962-200

✉ info@trotec.com

www.trotec.com