

**EN**

**ORIGINAL INSTRUCTIONS**  
AIR CLEANER



**Table of contents**

**Information on the use of these instructions** ..... 2

**Safety** ..... 2

**Information about the device** ..... 4

**Transport and storage** ..... 5

**Assembly and start-up** ..... 6

**Operation** ..... 11

**Available accessories** ..... 12

**Errors and faults** ..... 12

**Maintenance** ..... 13

**Disposal** ..... 14

**Technical annex** ..... 15

**EU Declaration of Conformity (original)** ..... 27

**Information on the use of these instructions**

**Symbols**

 **Danger**  
 This signal word indicates a hazard with a high risk level which, if not avoided, will result in serious injury or death.

 **Warning**  
 This signal word indicates a hazard with an average risk level which, if not avoided, can result in serious injury or death.

 **Warning of electrical voltage**  
 This symbol indicates dangers to the life and health of persons due to electrical voltage.

 **Caution**  
 This signal word indicates a hazard with a low risk level which, if not avoided, can result in minor or moderate injury.

**Notice**  
 This signal word indicates important information (e.g. material damage), but does not indicate hazards.

 **Info**  
 Information marked with this symbol helps you to carry out your tasks quickly and safely.



**Follow the manual**

Information marked with this symbol indicates that the instructions must be observed.

You can download the current version of these instructions via the following link:

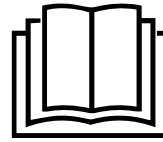

TAC 3500



<https://hub.trotec.com/?id=47617>

**Safety**

**Read this manual carefully before starting or using the device. Always store the manual in the immediate vicinity of the device or its site of use.**



**Warning**

**Read all safety warnings and all instructions.**

Failure to follow the warnings and instructions may result in electric shock, fire and/or serious injury.

**Save all warnings and instructions for future reference.**

This appliance can be used by children aged from 8 years and above and persons with reduced physical, sensory or mental capabilities or lack of experience and knowledge if they have been given supervision or instruction concerning use of the appliance in a safe way and understand the hazards involved.

Children shall not play with the appliance. Cleaning and user maintenance shall not be done by children without supervision.

- Do not use the device in potentially explosive rooms or areas and do not install it there.
- Do not use the device in an aggressive atmosphere.
- Place the device in an upright and stable position on a horizontal and stable surface.
- Let the device dry out after a wet clean. Do not operate it when wet.
- Do not use the device with wet or damp hands.
- Do not expose the device to directly squirting water.
- Never insert any objects or limbs into the device.
- Do not cover the device during operation.
- Do not sit on the device.
- This appliance is not a toy. Keep away from children and animals.
- Check accessories and connection parts for possible damage prior to every use of the device. Do not use any defective devices or device parts.

- Ensure that all electric cables outside of the device are protected from damage (e.g. caused by animals). Never use the device if electric cables or the power connection are damaged!
- The mains connection must correspond to the specifications in the Technical annex.
- Insert the mains plug into a properly fused mains socket.
- Observe the technical data when selecting extensions to the power cable. Completely unroll the extension cable. Avoid electrical overload.
- Before carrying out maintenance, care or repair work on the device, remove the mains plug from the mains socket. Hold onto the mains plug while doing so.
- Switch the device off and disconnect the power cable from the mains socket when the device is not in use.
- Do not under any circumstances use the device if you detect damages on the mains plug or power cable. If the supply cord is damaged, it must be replaced by a special cord or assembly available from the manufacturer or its service agent.  
Defective power cables pose a serious health risk!
- When positioning the device, observe the minimum distances from walls and other objects as well as the storage and operating conditions specified in the Technical annex.
- Make sure that the air inlet and outlet are not obstructed.
- Make sure that there are no loose items or dirt located in the immediate surroundings of air inlet and air outlet.
- Do not remove any safety signs, stickers or labels from the device. Keep all safety signs, stickers and labels in legible condition.
- Make sure that the suction side is kept free of dirt and loose objects.
- Dispose of replaced filters properly, especially after filtering substances hazardous to health.
- Never use the device as storage place or footstep.

### Intended use

Only use the device to clean atmospheric air from non-conducting and non-combustible dusts, fogs or suspended matter whilst using the appropriate filter classes and adhering to the technical data.

The device is intended to be used in commercial areas.

Any use other than the intended use is regarded as misuse.

### Reasonably foreseeable misuse

- Do not place the device on wet or flooded ground.
- Do not place any objects, e.g. clothing, on the device.
- Do not use outdoors.
- Do not use the device to siphon off vapours or fluids.
- Do not make any unauthorised modifications, alterations or structural changes to the device.

### Personnel qualification

People who use this device must:

- have basic knowledge of how to safely handle electrical equipment.
- have read and understood the instructions, especially the Safety chapter.

### Electrically skilled person

Electrically skilled personnel must be able to read and understand electric circuit diagrams, to put electrical systems into service and to maintain them, to wire control cabinets, to ensure the functionality of electrical components and to identify possible hazards from electrical and electronic systems.

### Instructed person

Instructed persons have been informed of the tasks they were entrusted with as well as of potential hazards resulting from inappropriate behaviour. They are allowed to operate and transport the device and perform simple maintenance activities (cleaning the housing, cleaning the fan).

The device is to be maintained and looked after by instructed personnel.

### Residual risks



#### Warning of electrical voltage

Work on the electrical components must only be carried out by an authorised specialist company!



#### Warning of electrical voltage

Before any work on the device, remove the mains plug from the mains socket!

Do not touch the mains plug with wet or damp hands. Hold onto the mains plug while pulling the power cable out of the mains socket.



#### Caution

Risk of injury from parts being whirled up!

Before switching the device on, make sure that there are no loose parts (clothing, hair ...) located near the air inlet or outlet!

**Notice**

Observe the overvoltage protection.

The device comes equipped with an overvoltage protection. When checking for electrical safety, please bear in mind that the test voltage has to be reduced to 250 V.

**Notice**

Do not operate the device without an air filter inserted into the air inlet!

Without the air filter, the inside of the device will be heavily contaminated. This can reduce the performance and result in damage to the device.

**Notice**

Do not use abrasive cleaners or solvents to clean the device.

**Behaviour in the event of an emergency**

1. Switch the device off.
2. Disconnect the device from the mains by removing the mains plug from the socket. When doing so, be sure to hold the plug, not the cable.
3. Do not reconnect a defective device to the mains.

**Information about the device****Device description**

Air cleaners are used to filter the room air. On building sites and renovation areas high concentrations of dust can arise, for instance when using angle grinders or during blasting, chiselling or demolition operations as well as when mixing dry mortar or tile cement.

Depending on the inserted filter, the air cleaners of the TAC series serve to eliminate various dusts, e.g. from asbestos, building rubble, quartz, flour, wood, etc., but also mould spores, paint particles and mineral fibres in the air, possibly arising during the above-mentioned operations.

This dust is to be vacuumed off as close as possible to the point of origin in order to reduce the pollution of the breathing air to a minimum. Depending on the used filter quality it is permissible to employ the device for the separation of quartziferous mineral dusts, wood dust, lead-containing dusts, artificial mineral fibres or high-temperature fibres.

Application as vacuum generator for mould remediation and asbestos abatement is also a possibility. In case of other hazardous substances there are additional requirements; hence observe the corresponding Technical Rules for Hazardous Substances (TRGS) or the country-specific regulations.

The device is suited for:

- producing a vacuum in a room, e.g. in heavily contaminated spaces;
- air purification in workspaces via air circulation, e.g. indoor building sites, workshops etc.;
- producing overpressure in a room, e.g. cleanroom;
- supplying filtered fresh air.

The device is structured as follows:

- housing with stacking aid
- adjustable fan for air transport
- filter monitoring for air volume flow

The device may be equipped with various filters. It provides the user with the possibility of configuring both the filter quality and the filter chain arrangement for the respective field of application. The filters must be selected according to the area of application.

The device is approvable for asbestos abatement as per TRGS 519, dust class H.

**Info**

The filters are not included in the scope of delivery! Choose the filters according to the area of application from our filter range. Insert the selected filters prior to initial start-up.

## Device depiction

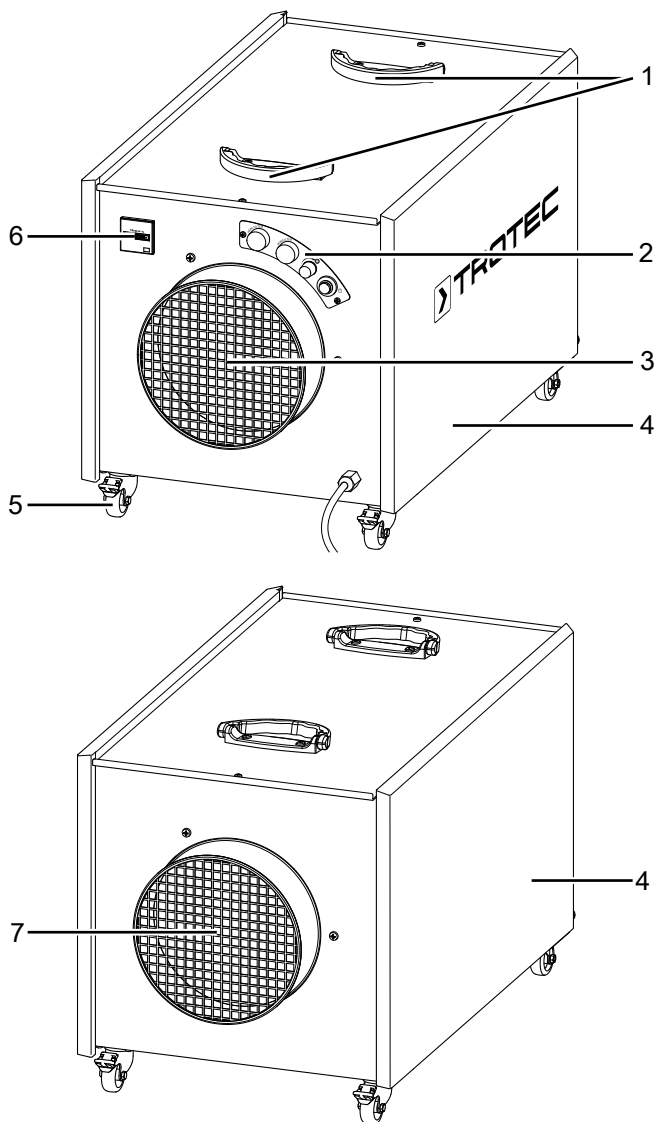

No.	Designation
1	transport handles
2	control panel
3	air outlet opening
4	side panel (service flap)
5	wheel
6	operating hours counter
7	air inlet opening

## Transport and storage

### Notice

If you store or transport the device improperly, the device may be damaged.  
Note the information regarding transport and storage of the device.

### Transport

**Before** transporting the device, observe the following:

- The device is switched off.
- The device is disconnected from the mains and the mains plug has been disconnected.

**After** transporting the device, proceed as follows:

- The device has been set up in an upright and stable position.

### Storage

When the device is not being used, observe the following storage conditions:

- Store the device in a dry location and protected from frost and heat.
- Store the device in an upright position where it is protected from dust and direct sunlight.
- If required, use a cover to protect the device from invasive dust.

**Assembly and start-up**

**Scope of delivery**

- 1 x Device
- 1 x Manual

**Unpacking the device**



**Warning**

There is a danger of suffocation for children due to packaging material! Keep packaging films and parts away from children. There is a risk of death due to suffocation.

1. Open the cardboard box and take the device out.
2. Completely remove the packaging.
3. Fully unwind the power cable. Make sure that the power cable is not damaged and that you do not damage it during unwinding.

**Assembly**

**Inserting the filters**



**Info**

The filters are not included in the scope of delivery! Choose the filters according to the area of application from our filter range. Insert the selected filters prior to initial start-up.

Prior to start-up the filter chain of the device must be configured according to the desired field of application. For this, two filter boxes are available.

The filter boxes are located behind the lateral service flaps (4).

1. For filter mounting remove the two side panels (4) towards the top.

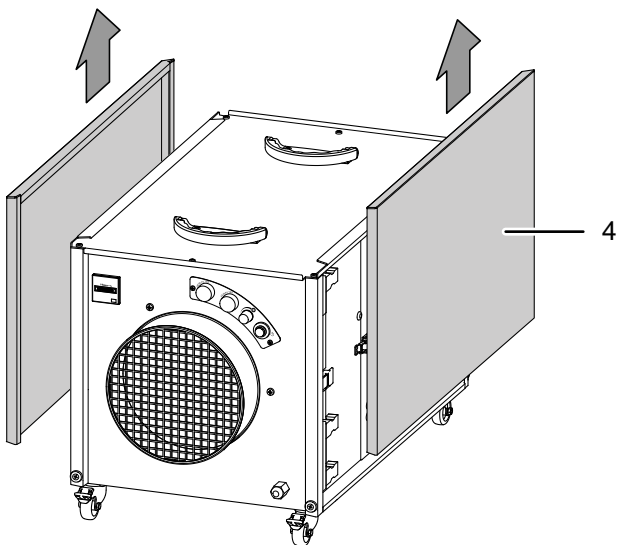

3. First pull out the tensioning frame (9).

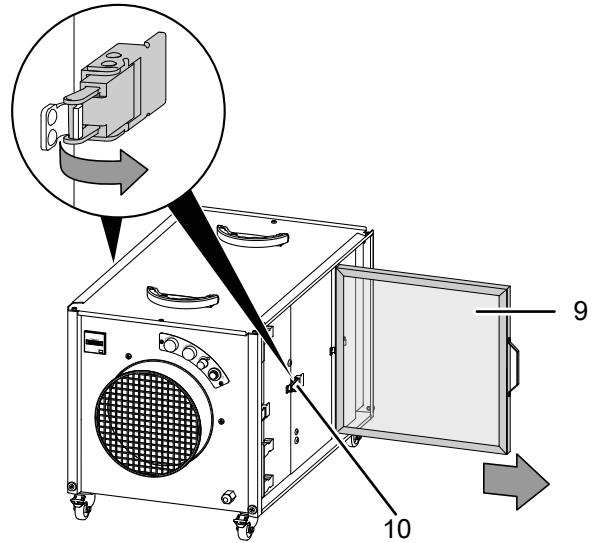

4. Remove further boxes from the device as required.

**Notice**

For all filter installations always observe the correct flow direction according to the direction of the air current (air flow direction: from back to front)!

**BOX 1: PRE-FILTER BOX**

The pre-filter box can be equipped with a coarse filter G and/or a fine filter F.

We recommend using at least one coarse filter for pre-cleaning, so as to maximize the service life of the subsequent filter.

- coarse filter G: Z-line filter G4 (14)
- fine filter F: pleated M5 to F9 (16)

The coarse filter is to be assembled in a way that it is the first in the air stream.

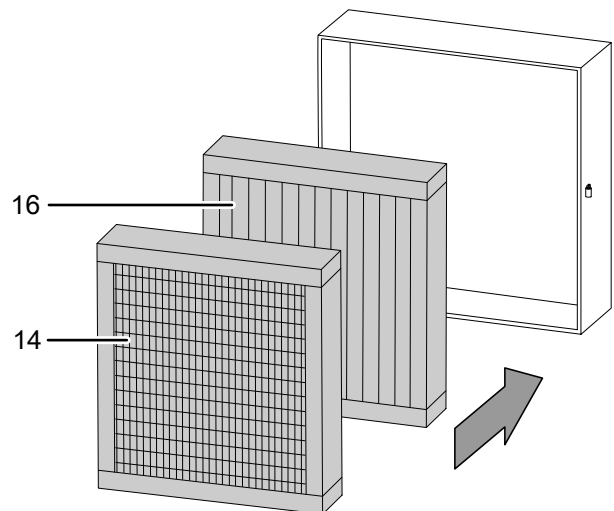

2. Open the tension locks (10) on both sides of the device.

## BOX 2: FILTER BOX

One of the following main filter types is inserted in the FILTER BOX.

### Version I:

High-efficiency particulate air filter: E10 to H14 or dust class M to H (15)

The high-efficiency particulate air filter is inserted in the filter box with its clip-on frame as follows:

1. Pull the clip-on frame out of the guiding grooves.
2. Attach the clip-on frame to the air outlet side of the HEPA filter.
3. Push HEPA filter and clip-on frame into filter box 2. Make sure that the clip-on frame again fits into the guiding grooves. If applicable, place the HEPA filter with the clip-on frame on a table and fit filter box 2 to the clip-on frame from above.

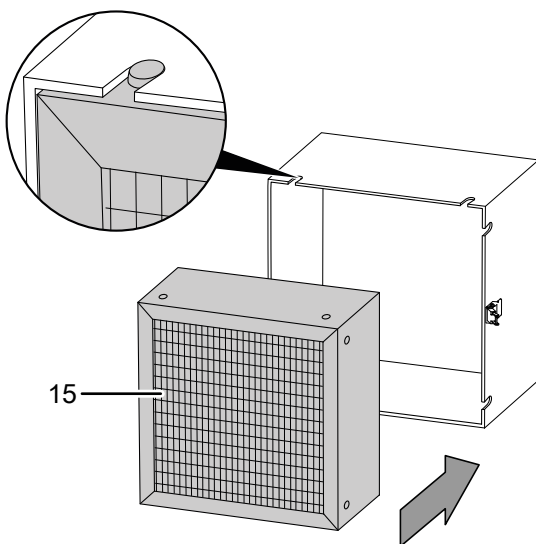

### Filter types (not included in the scope of delivery)

The designated air filters are especially geared to these devices and come with the largest possible filter surface based on the geometric dimensions. This ensures maximum air flow rate and service life for safe operation.

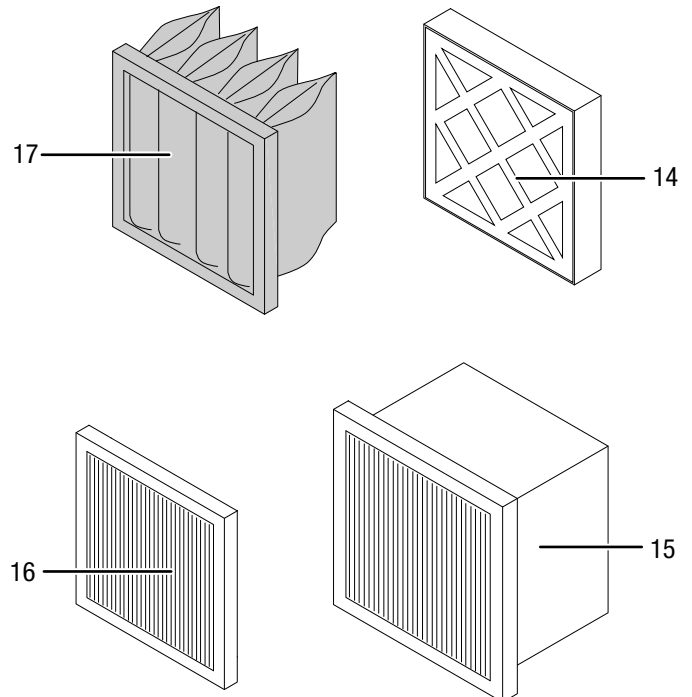

No.	Designation
14	Z-line filter G4
15	HEPA filter E10 to H14 / dust class M + H
16	pleated filter M5 to F9
17	bag filter M5 to F9

### Version II – alternative:

Bag filter: M5 to F9

When a bag filter is used, the fine filter in pre-filter box 1 may be omitted.

The bag filter is simply inserted in the filter box without further assembly. The clip-on frame does not need to be removed for this.

### Notice

When the device warns of a spent pre-filter (box 1) or main filter (box 2), still a flow rate of 500 m<sup>3</sup>/h (TAC 1500) or 1000 m<sup>3</sup>/h (TAC 3500) is ensured. For an effective filtration of pollutants the scheduled directives of the (German) employer's liability insurance association recommend to exchange the filter.

The Vario-shift function provides the user with the possibility of selecting the filter quality and the filter ladder according to the case of application and the applicable rules and regulations.

Filter ladder and configuration depend on the pollutant particle size, filtration efficiency and the field of application. The filter technology is monitored by sensors. For proper monitoring of the filter function sensor hose lines are connected to both filter boxes.

**Configuration A**

General configuration for the air filtration of coarse dusts and fine particulates or the separation of suspended matter according to EN 60335-2-69 up to dust class H. Here the filtration of dust particles and other suspended material harmful and hazardous to health has priority. The filter ladder must be operated in a vacuum, i.e. with terminal fan: the fan is to be arranged **downstream** of the main filter **FILTER BOX 2**.

**Configuration B**

Here air is usually lead from a contaminated area into a clean area, e.g. as filtered fresh air supply. Suspended matter as per EN 1822-1:1998 up to filter class H14 can be filtered, a higher filtration efficiency is possible with a reduced air volume. The filter ladder is operated at excess pressure, i.e. with terminal fine filter: the fan is to be arranged **upstream** of the main filter **FILTER BOX 2**.

The TAC series is equipped with Vario-shift function. This means that the filter elements can be variably arranged for all application scenarios and in line with the regulations.

Side view electrics:

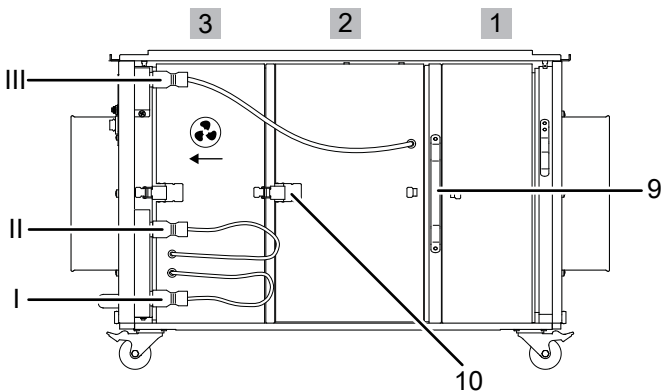

No.	Designation
1	PRE-FILTER BOX: COARSE FILTER G and/or FINE FILTER F
2	FILTER BOX: HEPA filter or bag filter
3	FAN BOX
I	connection for filter box 2
II	connection for fan control
III	connection for fan box 3
9	tensioning frame
10	tension lock

Side view sensor hose side:

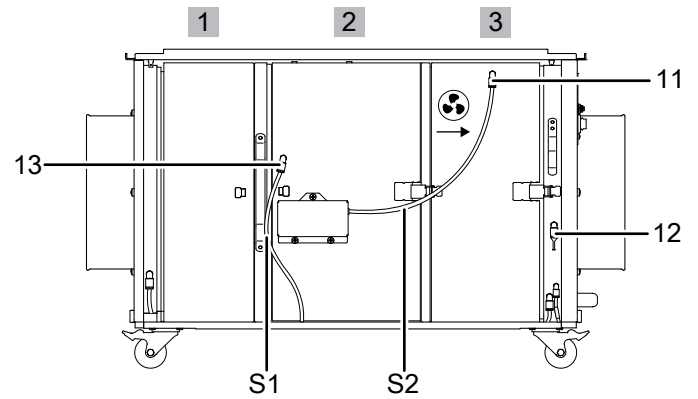

No.	Designation
S1	sensor hose S1
S2	sensor hose S2
11	measuring position for fan box 3
12	measuring position for frame (here with dummy plug)
13	measuring position for filter box 2

**Arranging and connecting filter boxes**

For maximum efficiency bag and Z-line filters are to be assembled vertically.

1. Place PRE-FILTER BOX 1 with inserted filter to the first position behind the air inlet opening.
2. Insert FILTER BOX 2 and FAN BOX 3 according to the desired configuration.
3. Insert the tensioning frame behind PRE-FILTER BOX 1.
4. Close all tension locks, both on the side of the electrics and on the sensor hose side.
5. Connect the cable connections on the side of the electrics to the corresponding plugs:

	Plug	Cable	Connection
<b>CABLE 1</b>	black	grey	III
<b>CABLE 2</b>	white	black	II
<b>CABLE 3</b>	black	black	I

Configuration A:

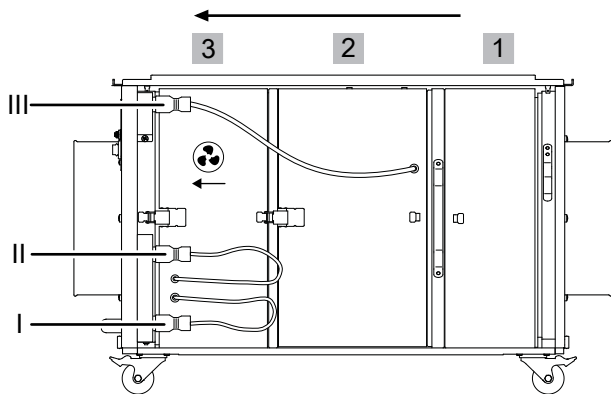

Configuration B:

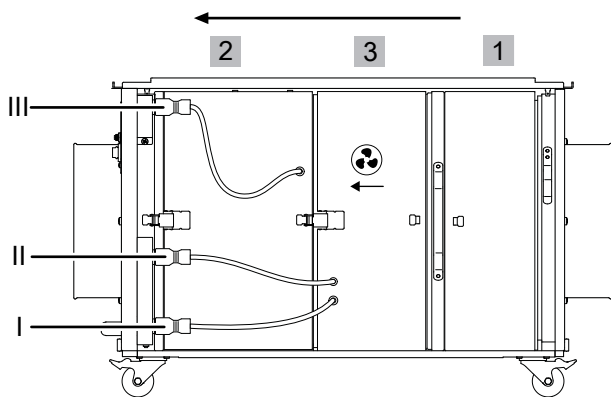

Then connect the two sensor hoses on the sensor hose side in accordance with the selected configuration:

**Configuration A**

- (11): sensor hose S2 => fan box 3
- (12): dummy plug B => frame
- (13): sensor hose S1 => filter box 2

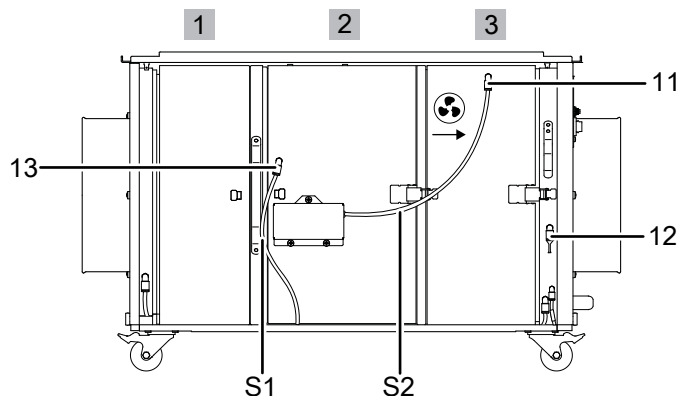

**Configuration B**

- (11): sensor hose S1 => fan box 3
- (12): sensor hose S2 => frame
- (13): dummy plug B => filter box 2

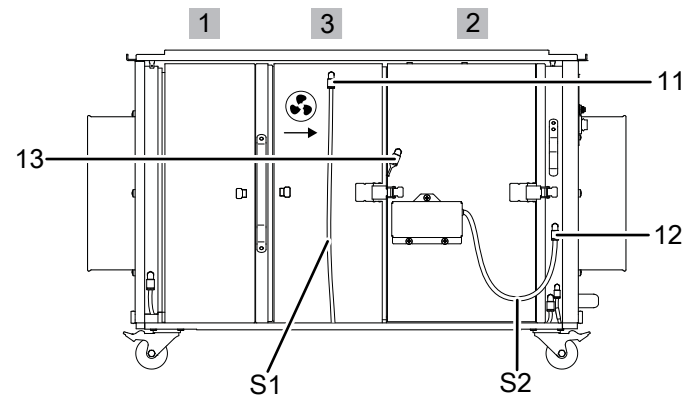

**Notice**

Push the sensor hoses **firmly** into the corresponding sensor socket until the hose securely clicks into place. The dummy plug has to be relocated depending on the configuration – for proper functioning the sensor sockets must not remain open.

In order to remove hose or dummy plug, press the outer ring of the measuring point and pull hose or dummy plug at the same time.

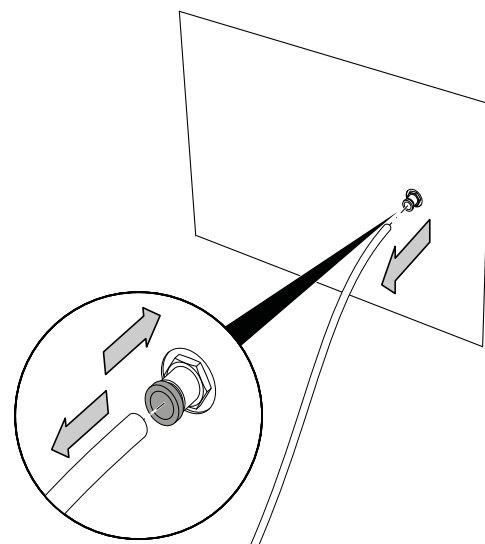

**Start-up**

When positioning the device, observe the minimum distance from walls or other objects as described in the chapter Technical annex.

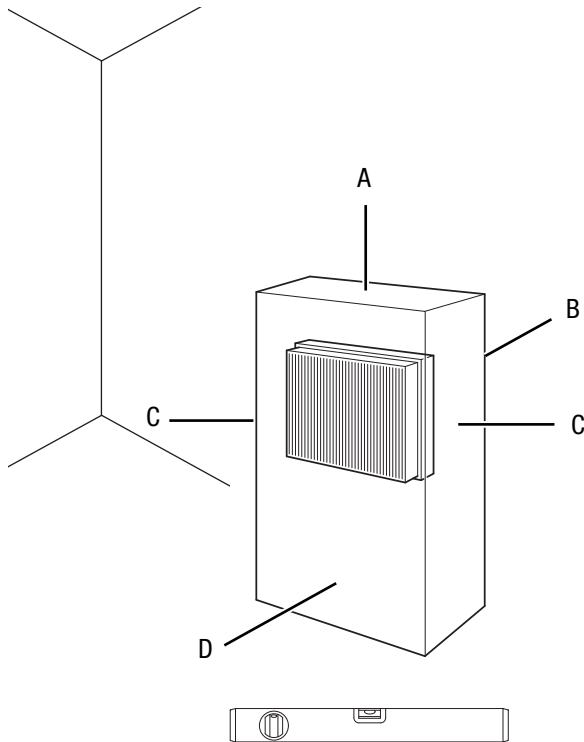

**Installation of the device in the room, the air of which is to be purified**

- When positioning the device, make sure it is located in the centre of the room the air of which is to be cleaned. Alternatively, you can also position the device near the source of air contamination.
- Prior to operation you have to ensure that the filters have been installed in the device as desired.
- Also check, whether the pressure sensors are connected correctly. If the device, during operation, emits a warning of a filter being spent, the respective filter has to be replaced.  
If the device issues a warning, although a new filter has only just been inserted, check whether all sensor hoses are firmly attached.
- The device works in recirculation mode, this means that the contaminated air enters the air cleaner via the air inlet opening and is blown out through the air outlet opening in purified state.

*Air purification in sealed off area via air circulation:*

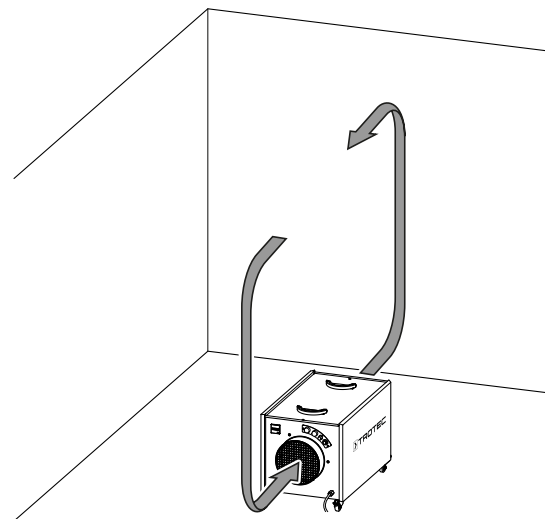

- Before restarting the device, check the condition of the power cable. If there are doubts as to the sound condition, contact the customer service.
- Place the device in an upright and stable position on a horizontal and stable surface.
- Do not create tripping hazards when laying the power cable or other electric cables, especially when positioning the device in the middle of the room. Use cable bridges.
- Ensure that the extension cables are completely unrolled.
- Position the device near the source of air contamination.
- When positioning the device, keep a sufficient distance to heat sources.
- Make sure that no curtains or other objects interfere with the air flow.
- Make sure that the air inlet and outlet are not obstructed.

## Installation of the device outside of the room, the air of which is to be purified

The device can be connected in either recirculation or ventilation mode.

- In recirculation mode, the air to be cleaned is led via a hose from the room into the air inlet opening of the device. The purified air is fed through another hose from the air outlet opening and back into the room.
- In ventilation mode, the air to be cleaned is led via a hose from the room into the air inlet opening of the device. This creates a slight negative pressure in the room. Clean, fresh air flows in from outside.

Installation variants for maintaining the pressure:

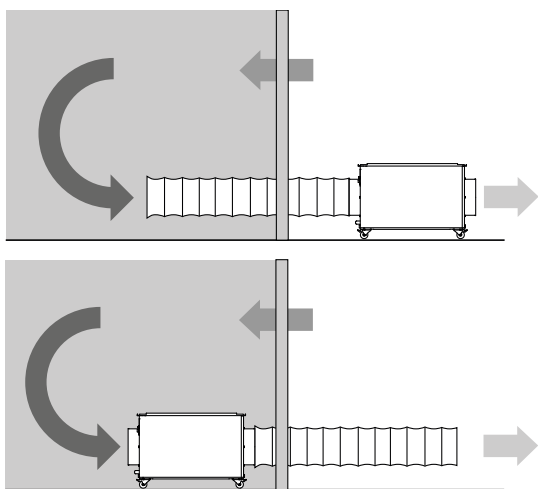

When connecting hoses, the following must be observed:

- The used pipes and hoses must be designed for the available static compression of the fans. They should preferably be laid in a straight line and at full length. 7.6 m of air hose each can be connected to the air inlet and air outlet openings of the device.
- There ought to be a minimum distance of 1 m between air inlet and air outlet opening.

### Connecting the power cable

- Connect the mains plug to a properly secured socket.

## Operation

### Operating elements

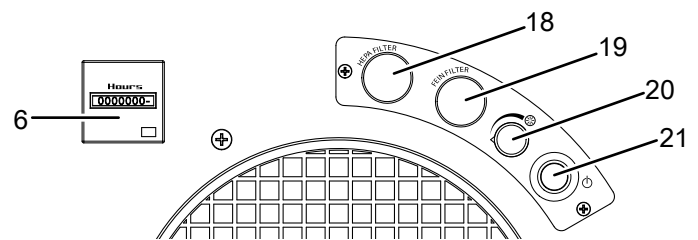

No.	Designation	Meaning
6	Operating hours counter	Indication of operating hours
18	Visual and acoustic filter change indicator FILTER BOX 2	Indication of required HEPA or bag filter change
19	Visual and acoustic filter change indicator PRE-FILTER BOX 1	Indication of required coarse or fine filter change
20	<i>Air volume</i> control dial	For setting the desired air volume
21	Power button	For switching the device on or off

### Switching the device on

1. Ensure that air inlet and outlet are not covered.
2. Turn the *air volume* control dial (20) counter-clockwise to the lowest air volume.
3. Press the *Power* button (21).  
⇒ The *Power* button (21) lights up.

### Adjusting the air volume

By use of the infinitely variable air flow regulation you can adjust the fan speed and thus regulate the air flow rate of the device.

With the filter arrangement G4, F7 and H13 to meet the requirements of dust class H, the device with connected exhaust air hose (7.6 m, laid in 2 90° arcs) reaches an air flow rate of 1150 m<sup>3</sup>/h.

If the filter change indicator (18) or (19) warns that a filter change will soon be required, a min. air flow rate of 1000 m<sup>3</sup>/h will still be ensured.

Exchange the corresponding filters in a timely manner.

1. To increase the air volume, turn the *air volume* control dial (20) clockwise.
2. To decrease the air volume, turn the *air volume* control dial (20) counter-clockwise.

**Shutdown**



**Warning of electrical voltage**

Do not touch the mains plug with wet or damp hands.

- Switch off the device.
- Disconnect the device from the mains by removing the mains plug from the socket. When doing so, be sure to hold the plug, not the cable.

**Available accessories**



**Warning**

Only use accessories and additional equipment specified in the instructions.

Using insertion tools or accessories other than those specified in the instructions may cause a risk of injury.

Designation	Article number
G4 Z-line filter / ISO coarse 75 %	7.160.000.428
F7 pleated filter cartridge / ISO ePM10 75 %	7.160.000.429
F7 bag filter / ISO ePM10 75 %	7.160.000.430
H13 HEPA filter approved for dust class H	7.160.000.431
G3 spray paint filter / ISO coarse 30 %	7.160.000.432
Activated carbon filter	7.160.000.434
Air transport hose Tronect SP-T, length 7.6 m	6.100.001.205

**Errors and faults**

The device has been checked for proper functioning several times during production. If malfunctions occur nonetheless, check the device according to the following list.

**The device does not start:**

- Check the power connection.
- Check the power cable and mains plug for damage.
- Check the on-site fusing.
- Wait for 10 minutes before restarting the device. If the device is not starting, have the electrics checked by a specialist company or by Trotec.

**The device is loud or vibrates:**

- Check whether the device is set up in a stable and upright position.

**The device gets very warm, is loud or is losing power:**

- Check the air inlet and air filter for dirt. Remove external dirt.

**The device gives off an unpleasant odour:**

- Smoke, e.g. dense tobacco smoke, odours and contaminations may be in the air. Ventilate the room.

**The device still does not operate correctly after these checks:**

Contact the manufacturer's customer service. If necessary, take the device to an authorised specialist electrical company or to the manufacturer for repair.

## Maintenance

### Activities required before starting maintenance



#### Warning of electrical voltage

Do not touch the mains plug with wet or damp hands.

- Switch the device off.
- Disconnect the device from the mains by removing the mains plug from the socket. When doing so, be sure to hold the plug, not the cable.



#### Warning of electrical voltage

Tasks which require the device to be opened must only be carried out by authorised specialist companies or by the manufacturer.

#### Notice

Observe the overvoltage protection.

The device comes equipped with an overvoltage protection. When checking for electrical safety, please bear in mind that the test voltage has to be reduced to 250 V.

### Cleaning the housing

Clean the housing with a soft, damp and lint-free cloth. Make sure that no moisture enters the housing. Protect electrical components from moisture. Do not use any aggressive cleaning agents such as cleaning sprays, solvents, alcohol-based or abrasive cleaners to dampen the cloth.

### Visual inspection of the inside of the device for dirt

1. Remove the air filters.
2. Use a torch to illuminate the openings of the device.
3. Check the inside of the device for dirt.
4. If you see a thick layer of dust, clean the inside of the device with a vacuum cleaner.
5. Reinsert the air filters.

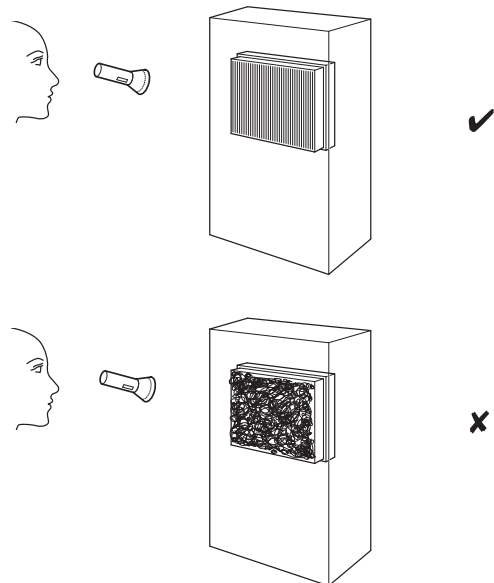

### Cleaning the inside of the device

1. First remove the filters and the filter frame as described in the Assembly and start-up chapter.
2. Clean the inside of the device and the filter frame with a soft, damp and lint-free cloth. Make sure that no moisture enters the housing. Protect electrical components from moisture. Do not use any aggressive cleaning agents such as cleaning sprays, solvents, alcohol-based or abrasive cleaners to dampen the cloth.
3. Reinsert the filters and the filter frame into the device.

### Changing the filter(s)

The filters must be changed if the filter change indicator for FILTER BOX 2 (18) or PRE-FILTER BOX 1 (19) lights up during operation and an acoustic signal is emitted.

If a filter needs to be replaced, please proceed as described in the Inserting the filters section in the Assembly and start-up chapter.

## Disposal

Always dispose of packing materials in an environmentally friendly manner and in accordance with the applicable local disposal regulations.



The icon with the crossed-out wheeled bin indicates that this device and any associated components must not be disposed of with household waste at the end of their life, in accordance with the Waste Electrical and Electronic Equipment Directive (2012/19/EU) and national laws.

You will find collection points for free return of waste electrical and electronic equipment in your vicinity. The addresses can be obtained from your municipality or local administration. You can also find out about other return options that apply for many EU countries on the website <https://hub.trotec.com/?id=45090>. Otherwise, please contact an official recycling centre for electronic and electrical equipment authorised for your country.

The separate collection of waste electrical and electronic equipment aims to enable the re-use, recycling and other forms of recovery of waste equipment as well as to prevent negative effects for the environment and human health caused by the disposal of hazardous substances potentially contained in the equipment.

### Only for United Kingdom

According to Waste Electrical and Electronic Equipment Regulations 2013 (SI 2013/3113) (as amended) devices that are no longer usable must be collected separately and disposed of in an environmentally friendly manner.

## Technical annex

## Technical data

Parameter	Value
<b>Model</b>	<b>TAC 3500</b>
Article number	1.580.000.117
Recommended amount of air for dust class H	1000 m <sup>3</sup> /h
Dust class (as per DIN 60335-2-69)	dust class H (transmittance $\leq 0.005\%$ ) for substances with a max. allowable concentration of $\leq 0.1$ mg/m <sup>3</sup> , carcinogenic hazardous substances as per GefStoffV § 11 (Ordinance on Hazardous Substances), TRGS 905 or 906 (Technical Rules for Hazardous Substances), approvable for asbestos abatement as per TRGS 519
Motor power	450 W
Power supply	1/N/PE $\sim$ 230 V / 50–60 Hz
Nominal current	2.8 A
Connection cable	CEE 7/7, cable length 3 m rubber conduit (H05RR-F3G1) length = 3.5 m
Air transport hose connector inlet/ outlet side	250 mm
Sound level (at a distance of 1 m)	65 dB(A)
Dimensions (length x width x height)	885 x 460 x 532 mm
Weight	36 kg

### Recommendation for filter combinations specific to the application and corresponding room size suitability

		suitable for rooms sized up to <sup>1)</sup>	
Fields of application	Filter combination	m <sup>3</sup>	m <sup>2</sup>
Coarse dust <sup>2)</sup> ( $\leq 3$ ACH <sup>6)</sup> )	G4	500	170
Fine particulates <sup>3)</sup> ( $\leq 3$ ACH <sup>6)</sup> )	G4 + F7 to F9	270	90
Suspended matter <sup>4)</sup> ( $\leq 3$ ACH <sup>6)</sup> )	G4 + H13	100	34
Hygienic areas <sup>5)</sup> ( $\leq 3$ ACH <sup>6)</sup> )	G4 + H13	70	23

<sup>1)</sup> With an assumed room height of 3 m; <sup>2)</sup> Typical coarse dust tasks: sawing, filing; <sup>3)</sup> Typical fine dust tasks: restoration works with materials containing minerals or glass wool; <sup>4)</sup> Typical suspended matter tasks: grinding, asbestos abatement or mould remediation, mineral dusts etc.; <sup>5)</sup> H13 downstream; <sup>6)</sup> Air exchange per hour

### Optional equipment (upon request)

Guiding wheels with pneumatic tyres, traceless

Trestle rollers (instead of guiding wheels)

Fork pockets for fork lifts

**Performance chart**

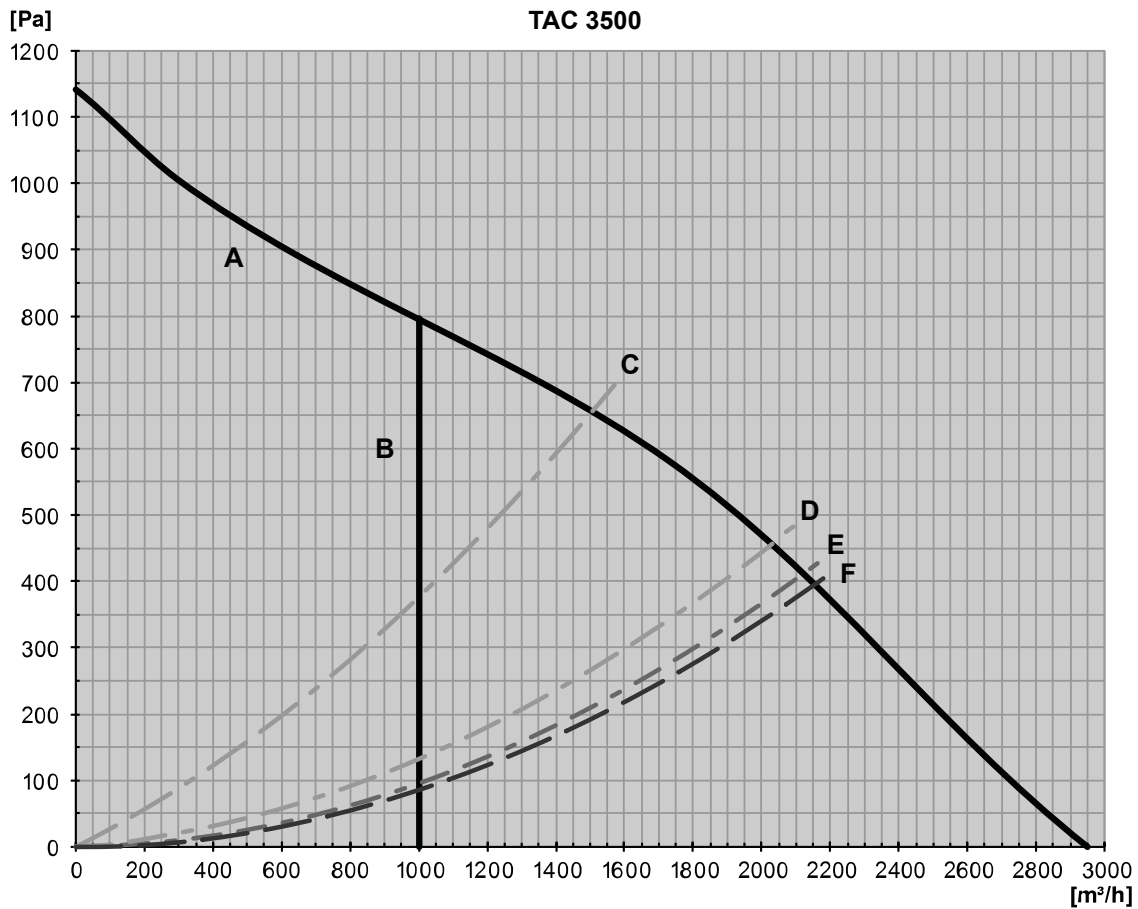

A	Fan
B	Recommended amount of air for dust class H
C	With G4+H13 filter combination (approval for dust class H) and air transport hose*
D	With G4+F7 filter combination and air transport hose*
E	With G4 filter and air transport hose*
	With spray paint filter and air transport hose*
F	Without filter, with air transport hose*

\* Connected to the pressure side, standard length 7.6 m, laid with one 90° arc. **When the air hose is laid stretched and arc-free, an increase of air volume by up to 25 % is possible!**

## Overview



### Info

The position numbers of the spare parts differ from those describing the positions of the components mentioned in these instructions.

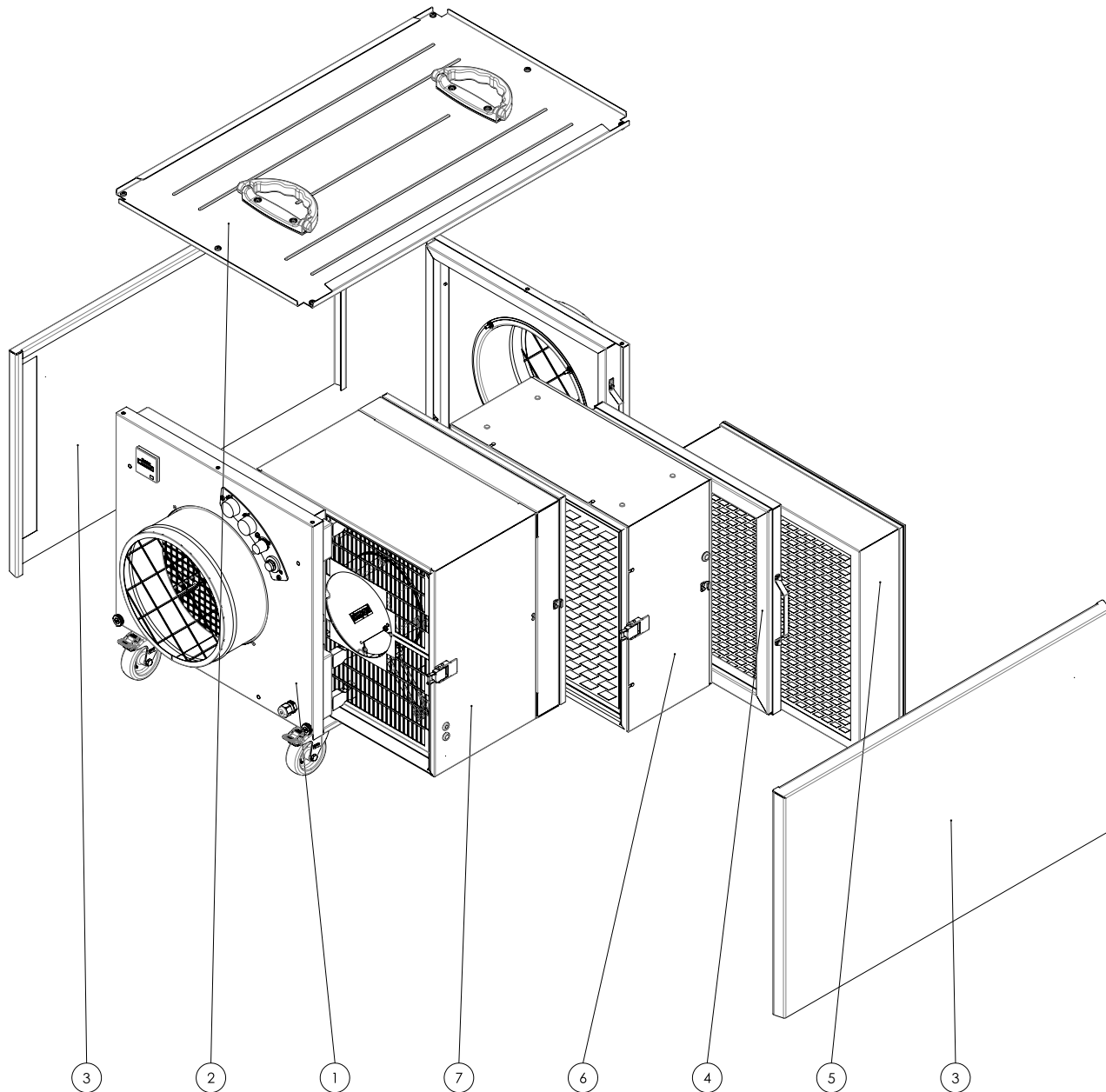

No.	Designation	Article number	No.	Designation	Article number
1	Basic housing	ZAT0004855	5	Paper filter	ZAT0003486
2	Cover	ZAT0004859	6	HEPA	ZAT0003493
3	Panel	P10008268	7	Fan housing	B1555
4	Tension element	ZAT0003483			

**Dimensions**



**Info**

The dimensions are given in millimetres.

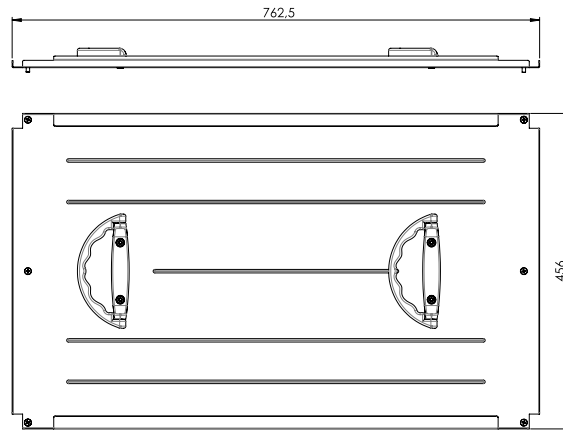
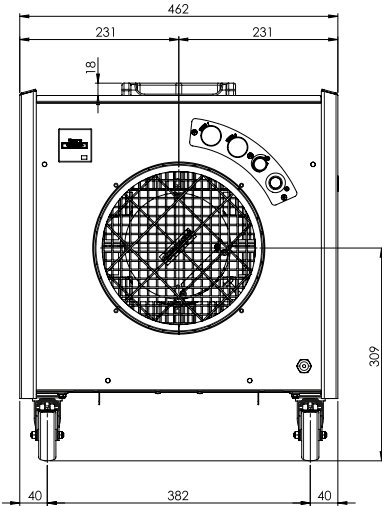
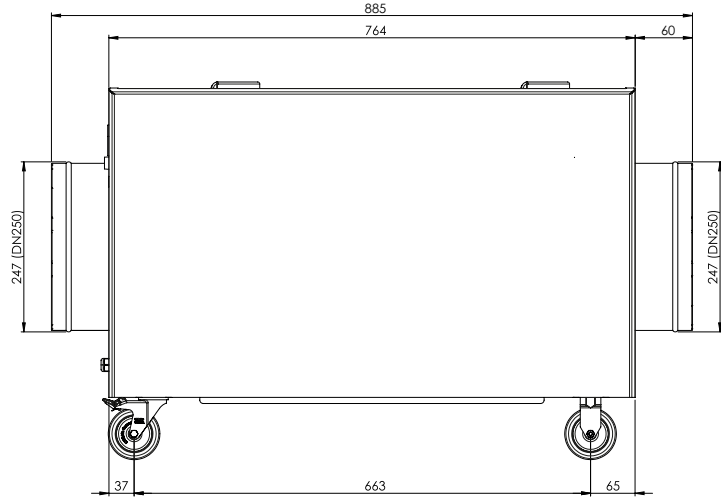
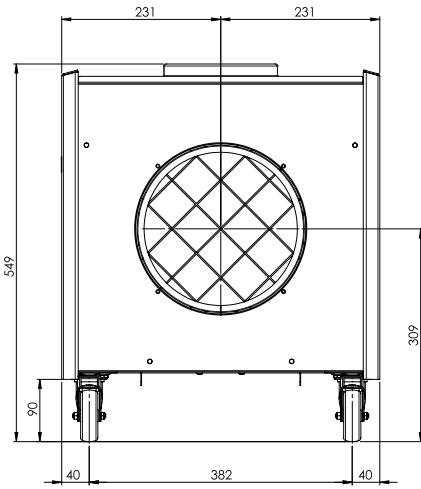

**Basic housing**



**Info**

The position numbers of the spare parts differ from those describing the positions of the components mentioned in these instructions.

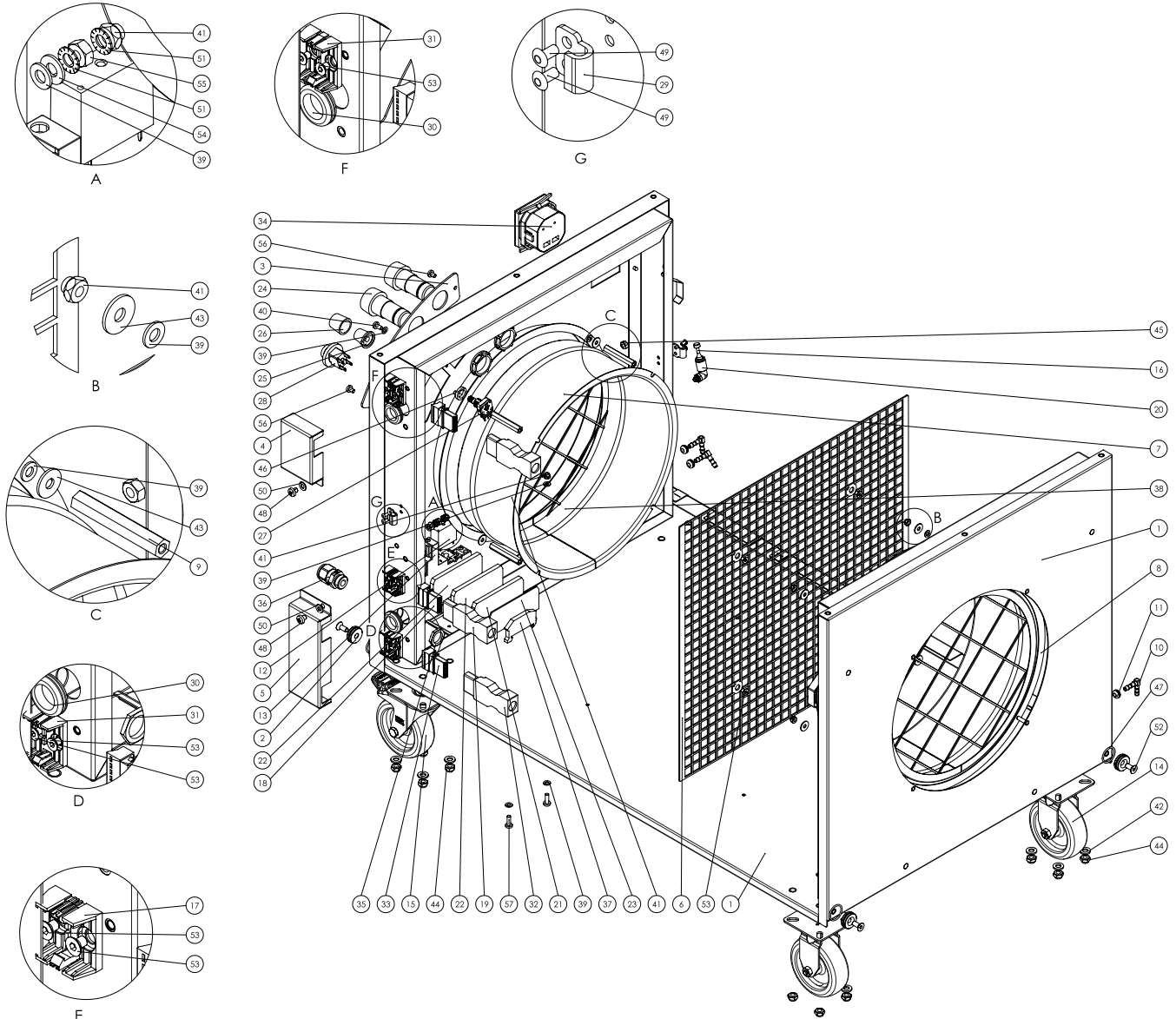

No.	Designation	Article number	No.	Designation	Article number
1	Basic housing SBG	P10008269	30	Sealing plug	P10000651
2	Guide bushing	P10001409	31	Mounting plate	P10000646
3	Operating element	P10008202	32	Plug	P10000644
4	Mounting bracket	P10002156	33	Socket	P10000645
5	Mounting bracket	P10002155	34	Operating hours counter	P10001137
6	Touch protection	P10002218	35	Nut	P10003618
7	Flanged collar	P10000654	36	Cable gland	P10007561
8	Gasket strip	P10000357	37	End stop	P10001031
9	Spacer sleeve	P10001596	38	Diff. pressure switch	P10001733
10	Angle piece	P10000562	39	Washer	P10001310
11	Pass-through sleeve	P10001418	40	Screw	P10000322
12	Relay	P10000042	41	Nut	P10000013
13	Mounting clip	P10000043	42	Washer	P10000019
14	Trestle roller	P10001531	43	Washer	P10000449
15	swivel castor	P10001530	44	Nut	P10000500
16	Sealing plug	P10001646	45	Nut	P10000006
17	Mounting plate	P10000649	46	Washer	P10000364
18	Socket	P10000648	47	O-ring	P10001421
19	Plug	P10000647	48	Screw	P10001179
20	Angle fitting	P10001306	49	Rivet	P10001108
21	Feed-through terminal	P10001026	50	Washer	P10001134
22	Feed-through terminal	P10001028	51	Washer	P10001112
23	End plate	P10001029	52	Screw	P10000336
24	Signal lamp	P10002353	53	Screw	P10003856
25	Rotary button	P10001250	54	Washer	P10000038
26	Cap	P10001249	55	Nut	P10000208
27	Potentiometer	P10001751	56	Screw	P10001010
28	Switch	P10001376	57	Screw	P10000443
29	Locking hook	P10000616			

**Cover**



**Info**

The position numbers of the spare parts differ from those describing the positions of the components mentioned in these instructions.

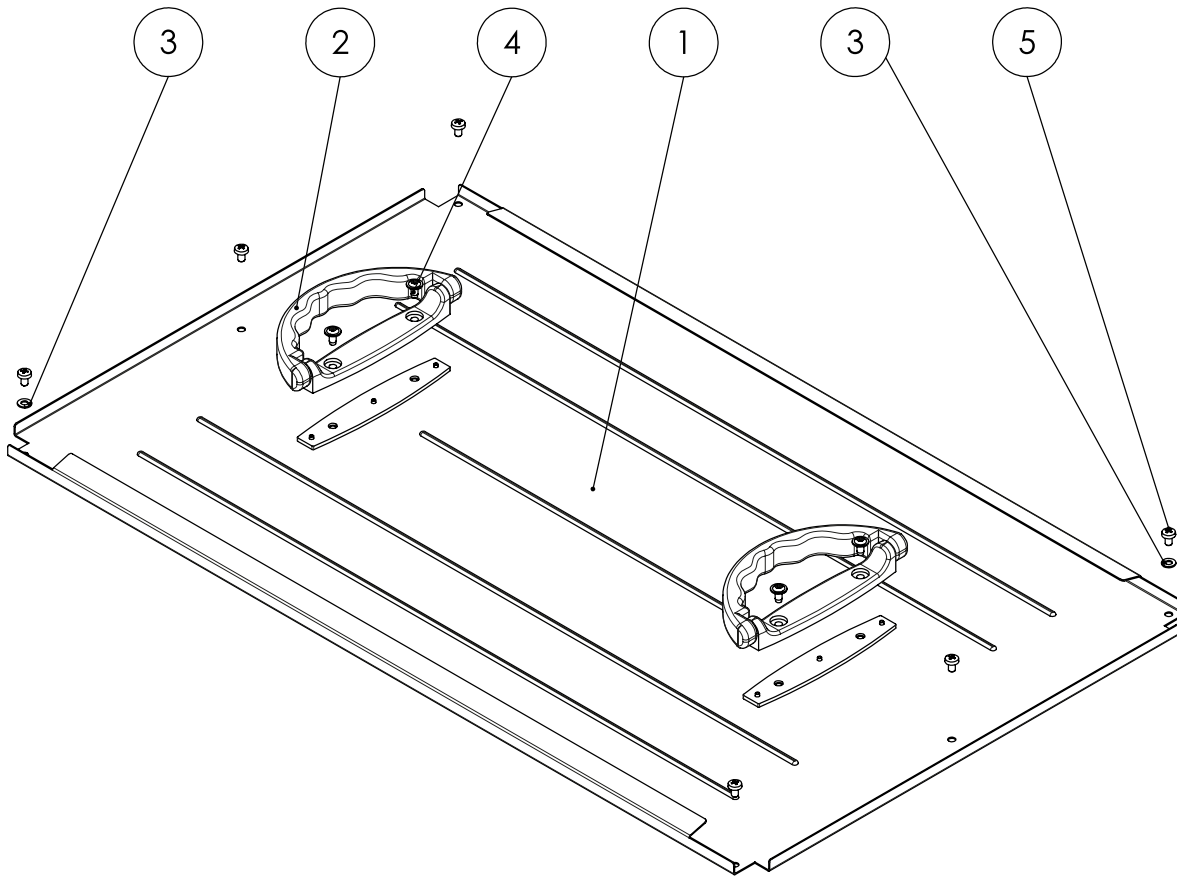

No.	Designation	Article number	No.	Designation	Article number
1	Cover SBG	P10008270	4	Screw	P10000568
2	Handle	P10001246	5	Screw	P10001265
3	Washer	P10001134			

**Tension element**



**Info**

The position numbers of the spare parts differ from those describing the positions of the components mentioned in these instructions.

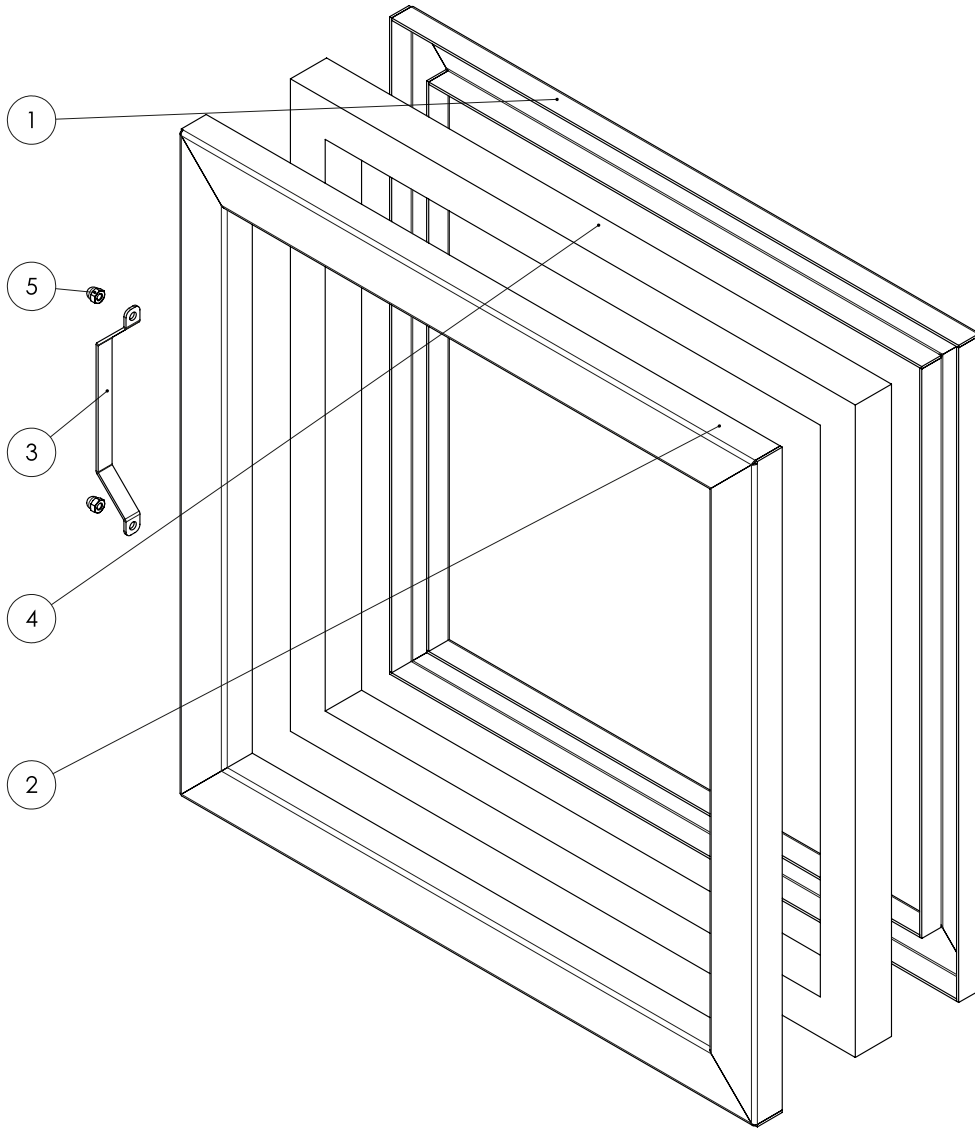

No.	Designation	Article number	No.	Designation	Article number
1	Tensioning frame	P10002210	4	Seal	P10001422
2	Tensioning frame SBG	P10002217	5	Nut	P1000768
3	Handle	P10002158			

## HEPA filter



### Info

The position numbers of the spare parts differ from those describing the positions of the components mentioned in these instructions.

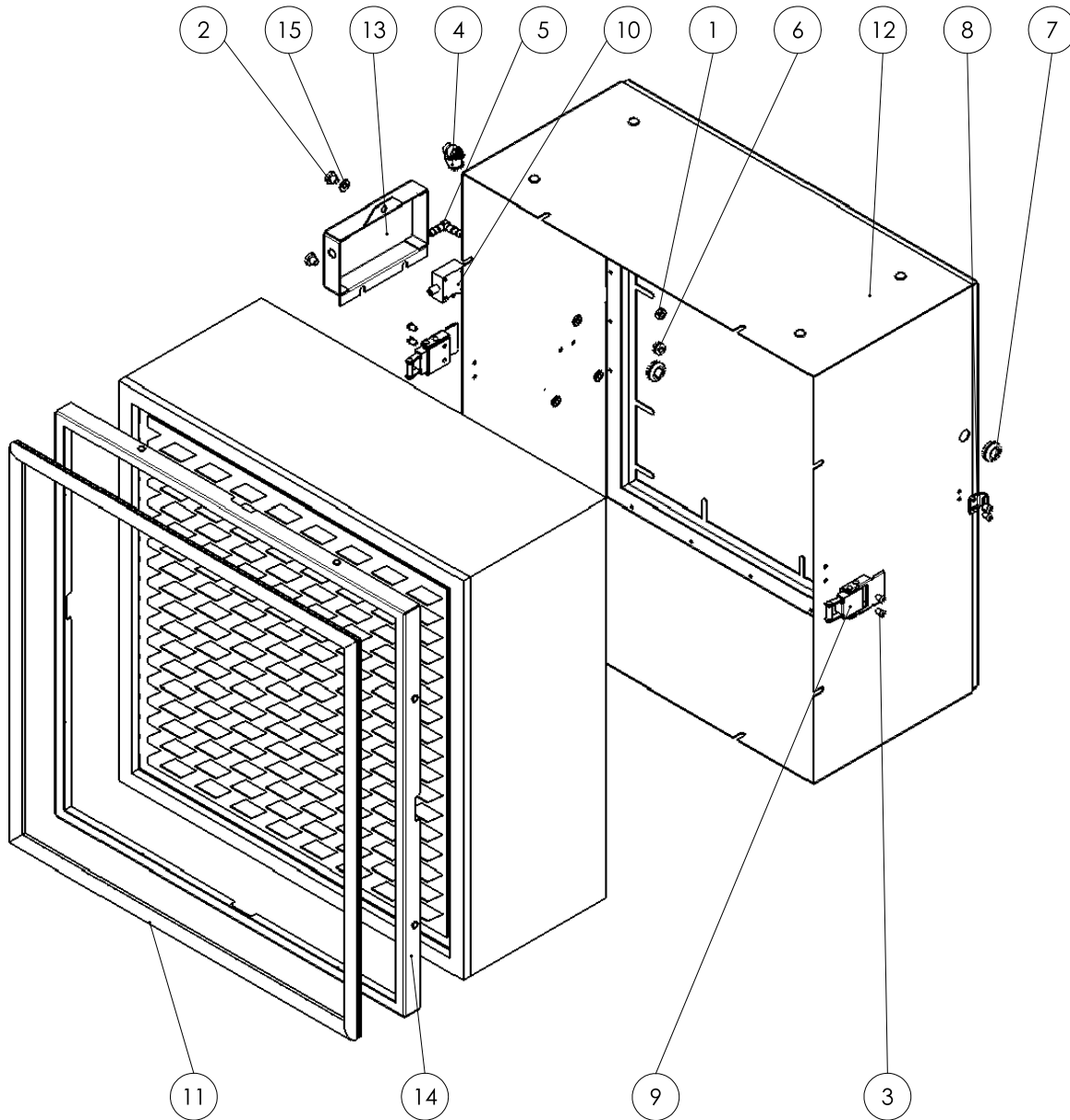

No.	Designation	Article number	No.	Designation	Article number
1	Nut	P10000006	9	Spring tension element	P10000615
2	Screw	P10001179	10	Diff. pressure switch	P10001733
3	Rivet	P10001108	11	Seal	P10001855
4	Angle fitting	P10001306	12	HEPA frame SBG	P10002212
5	Angle piece	P10000562	13	Supply box	P10002149
6	Pass-through sleeve	P10001418	14	HEPA frame	P10002214
7	Pass-through sleeve	P10002306	15	Washer	P10001134
8	Locking hook	P10000616			

**Fan housing**



**Info**

The position numbers of the spare parts differ from those describing the positions of the components mentioned in these instructions.

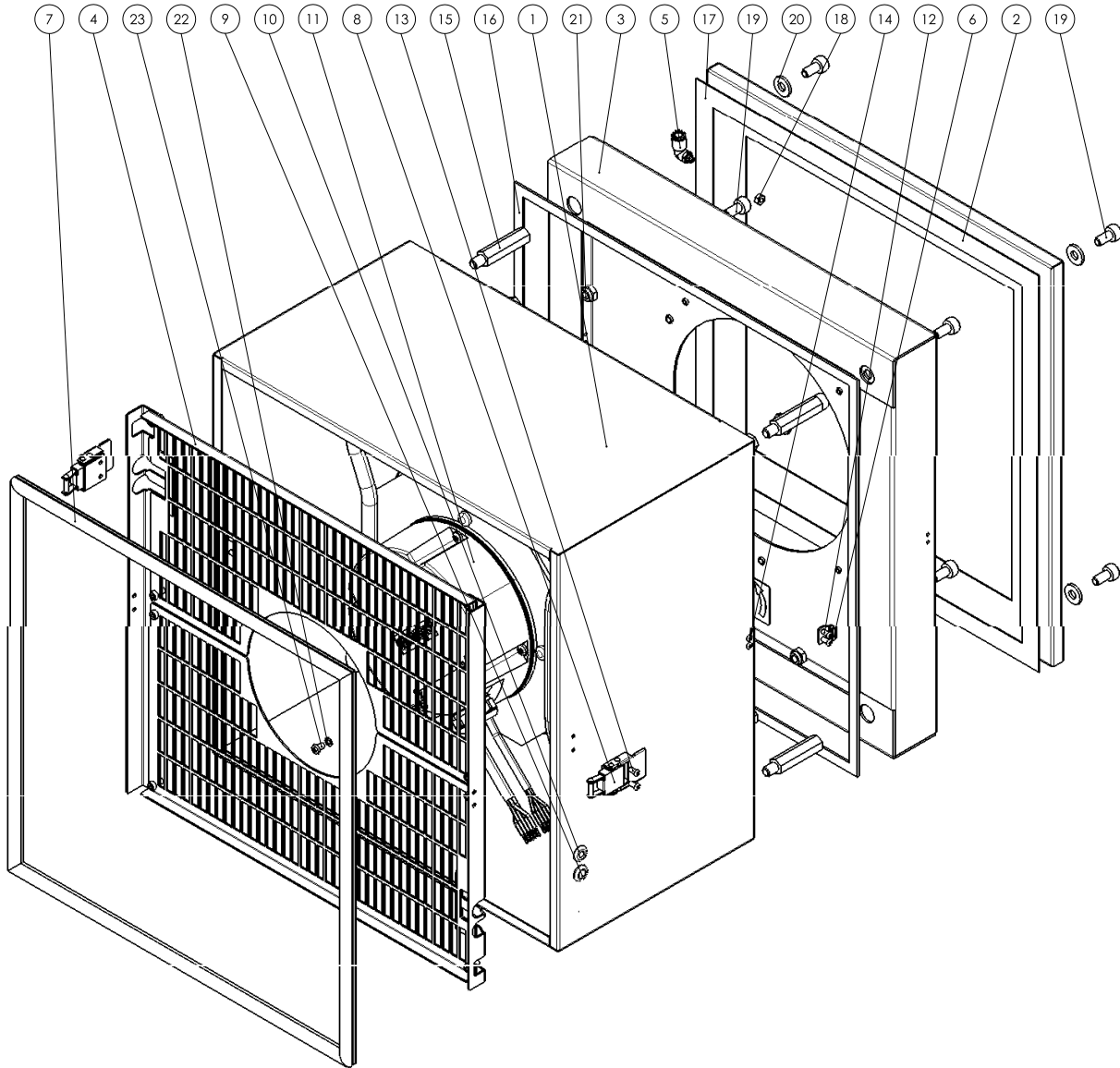

No.	Designation	Article number	No.	Designation	Article number
1	Fan frame SBG	P10002211	13	Blind rivet	P10007233
2	Fan inlet	P10002216	14	Rivet	P10001108
3	Spacer frame	P10008258	15	Spacer sleeve	P10008216
4	Tamper protection	B1554	16	Gasket strip	P10000357
5	Angle fitting	P10001306	17	Gasket strip	P10007745
6	Locking hook	P10000616	18	Nut	P10000006
7	Seal	P10001855	19	Screw	P10000424
8	Spring tension element	P10000615	20	Washer	P10004279
9	Feed-through	P 1000 1679	21	Nut	P10000099
10	Feed-through	P10001417	22	Washer	P10001112
11	Fan	P10002324	23	Screw	P10000032
12	Blind rivet	P10001966			

**Paper filter**



**Info**

The position numbers of the spare parts differ from those describing the positions of the components mentioned in these instructions.

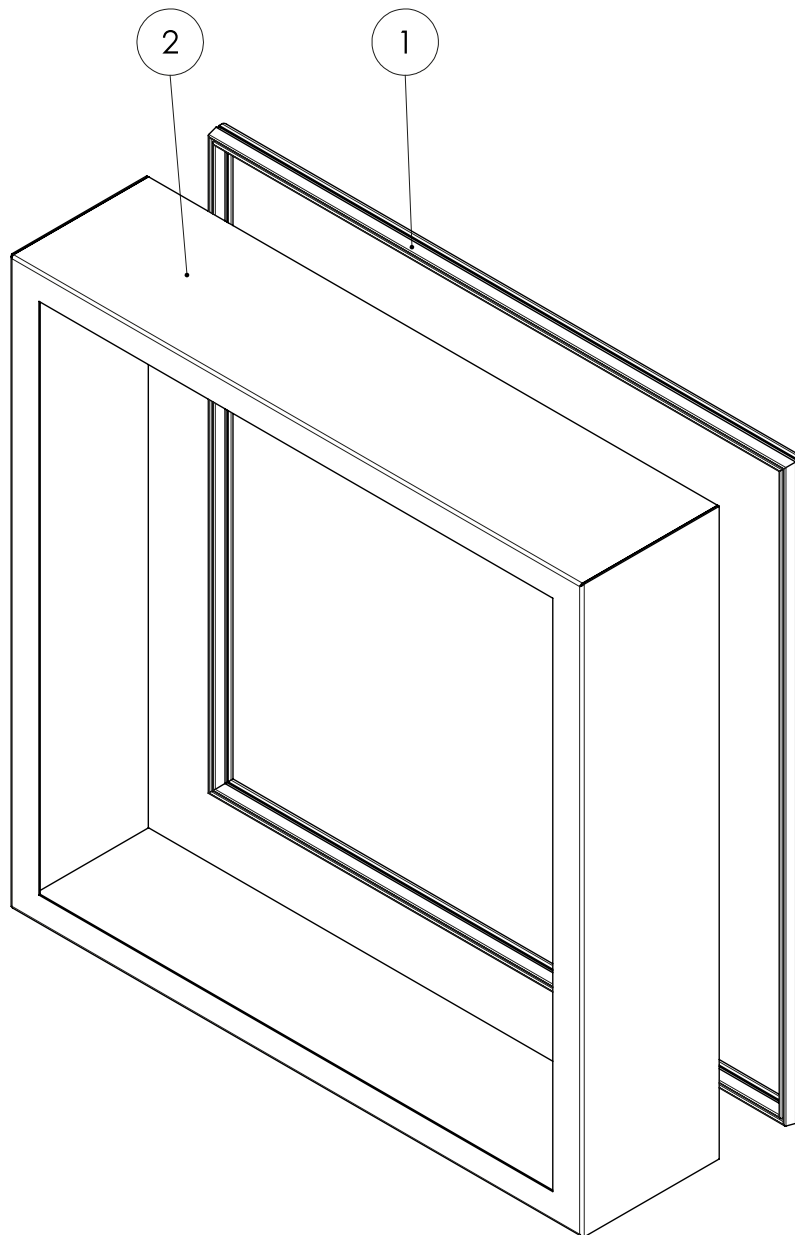

No.	Designation	Article number	No.	Designation	Article number
1	Seal	P10000290	2	Prefilter frame	P10002213

**Circuit diagram**

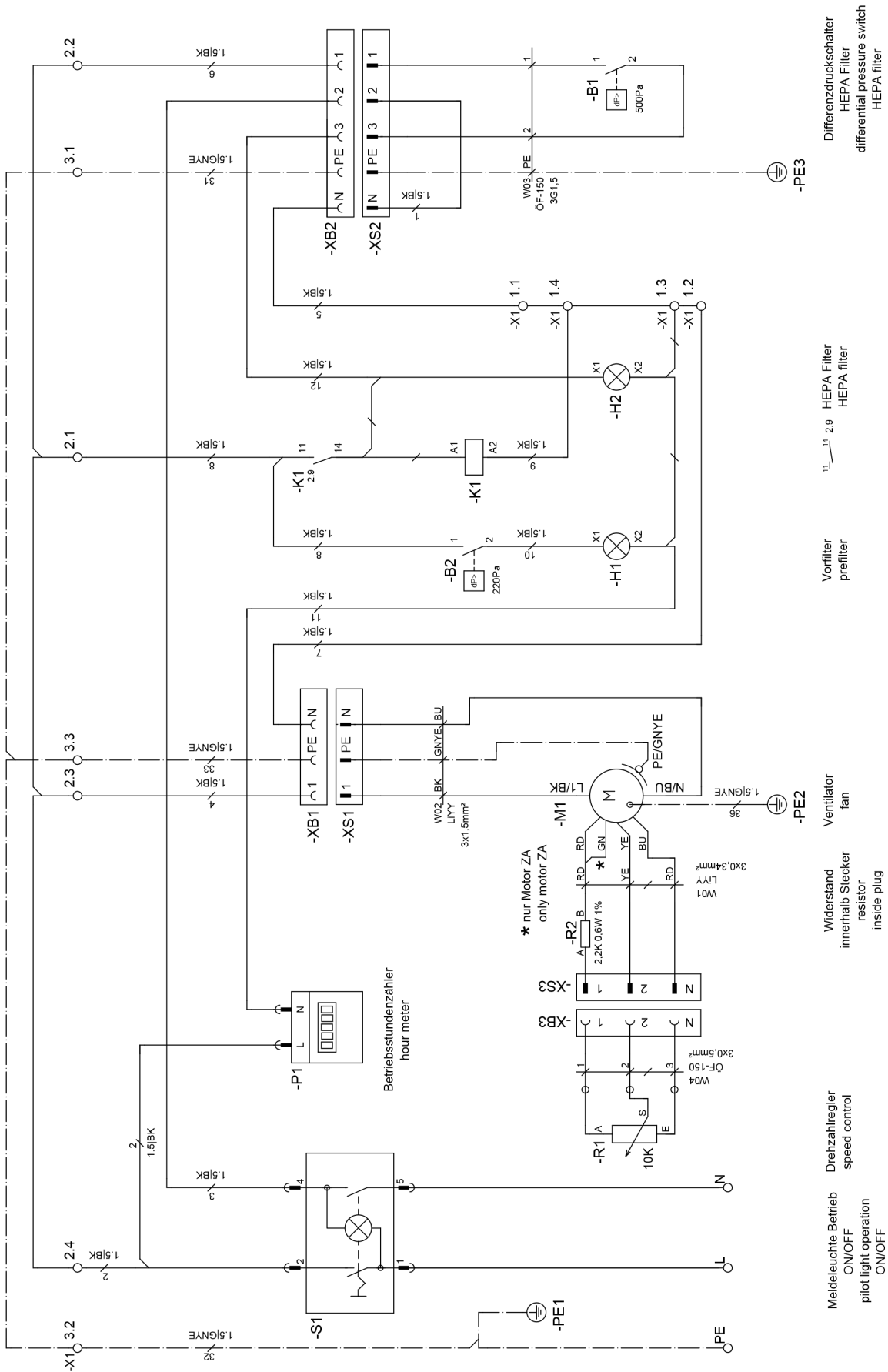

## EU Declaration of Conformity (original)

Declaration of conformity in accordance with the EC Machinery Directive 2006/42/EC, Annex II, Part 1, Section A

We – Trotec GmbH – declare in sole responsibility that the product designated below was developed, constructed and produced in compliance with all relevant provisions of the EC Machinery Directive in the version 2006/42/EC.

**Product model / Product:** TAC 3500

**Product type:** air cleaner

**Year of manufacture as of:** 2024

**The product also complies with all relevant provisions of the following directives/regulations:**

- 2011/65/EU
- 2014/30/EU

**Applied harmonised standards:**

- EN ISO 12100:2010
- EN ISO 13849-1:2015
- EN ISO 13857:2019
- EN ISO 14118:2018
- EN 55011:2016
- EN 55011:2016/A1:2017
- EN 55011:2016/A11:2020
- EN 60204-1:2018
- EN 60335-1:2012
- EN 60335-1:2012/AC:2014
- EN 60335-1:2012/A11:2014
- EN 60335-1:2012/A13:2017
- EN 60335-1:2012/A15:2021
- EN 60335-2-65:2003
- EN 60335-2-65:2003/A11:2012

**Applied national standards and technical specifications:**

- EN 55011:2016/A2:2012
- EN 60335-1:2012/A16:2023
- EN 60335-2-65:2003/A1:2008
- EN 60335-2-65:2003/A12:2022
- EN 60335-2-65:2003/A2:2022
- EN 60335-2-65:2003/C1:2004
- EN 62233:2008

**Manufacturer and name of the authorised representative of the technical documentation:**

Trotec GmbH

Grebbener Straße 7, D-52525 Heinsberg

Phone: +49 2452 962-400

E-mail: info@trotec.de

Place and date of issue:

Heinsberg, 17.11.2024



Joachim Ludwig, Managing Director

Trotec GmbH

Grebbener Str. 7  
52525 Heinsberg  
Germany

☎ +49 2452 962-0

☎ +49 2452 962-200

✉ [online@trotec.com](mailto:online@trotec.com)

[www.trotec.com](http://www.trotec.com)